

OXIDAL
your_project_partner



**Sistemi vetrine
e mensole**

Showcases and
shelves systems

Cerniere per vetrine e mobili

Hinges for showcases and furnitures

art. 111



Cerniera sfalsata piccola bassa
Offset small bottom hinge

argento/silver	bronzo / bronze	oro / gold	nero / black	verniciato / powder	cromato / chrome	oro luc. / bright gold	crom. sat / chro. mat
N-0111-A	N-0111-B	N-0111-O	N-0111-N	N-0111-V	N-0111-C	N-0111-L	N-0111-I

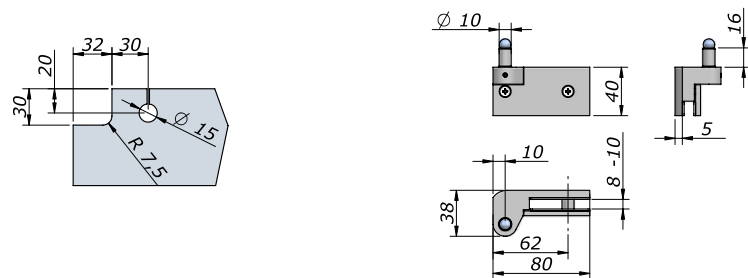

art. 112



Cerniera sfalsata piccola alta
Offset small top hinge

argento/silver	bronzo / bronze	oro / gold	nero / black	verniciato / powder	cromato / chrome	oro luc. / bright gold	crom. sat / chro. mat
N-0112-A	N-0112-B	N-0112-O	N-0112-N	N-0112-V	N-0112-C	N-0112-L	N-0112-I



art. 111A



Cerniera piccola bassa
Small bottom hinge

argento/silver	bronzo / bronze	oro / gold	nero / black	verniciato / powder	cromato / chrome	oro luc. / bright gold	crom. sat / chro. mat
N-111A-A	N-111A-B	N-111A-O	N-111A-N	N-111A-V	N-111A-C	N-111A-L	N-111A-I

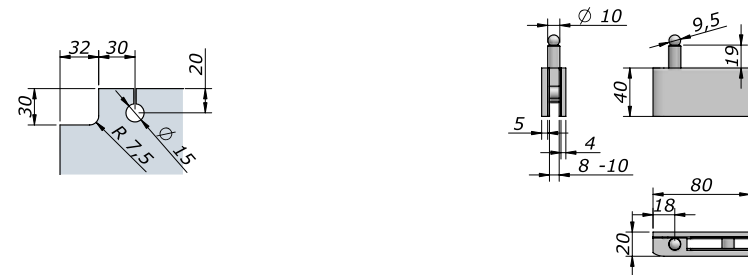

art. 112A



Cerniera piccola alta
Small top hinge

argento/silver	bronzo / bronze	oro / gold	nero / black	verniciato / powder	cromato / chrome	oro luc. / bright gold	crom. sat / chro. mat
N-112A-A	N-112A-B	N-112A-O	N-112A-N	N-112A-V	N-112A-C	N-112A-L	N-112A-I

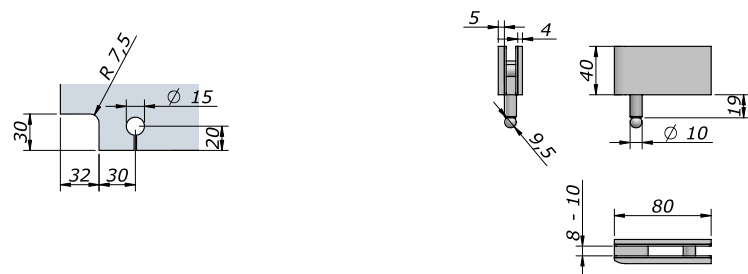

art. 316



Bussola a pavimento piccola
Small floor bush

argento/silver	bronzo / bronze	oro / gold	nero / black	verniciato / powder	cromato / chrome	oro luc. / bright gold	crom. sat / chro. mat
N-0316-A	N-0316-B	N-0316-O	N-0316-N	N-0316-V	N-0316-C	N-0316-L	N-0316-I

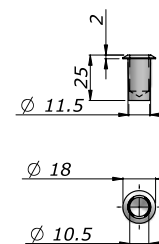

art. 160



Cerniera orizzontale per mobili
Horizontal hinge for furniture

argento/silver	bronzo / bronze	oro / gold	nero / black	verniciato / powder	cromato / chrome	oro luc. / bright gold	crom. sat / chro. mat
N-0160-A-DX	N-0160-B-DX	N-0160-O-DX	N-0160-N-DX	N-0160-V-DX	N-0160-C-DX	N-0160-L-DX	N-0160-I-DX
N-0160-A-SX	N-0160-B-SX	N-0160-O-SX	N-0160-N-SX	N-0160-V-SX	N-0160-C-SX	N-0160-L-SX	N-0160-I-SX

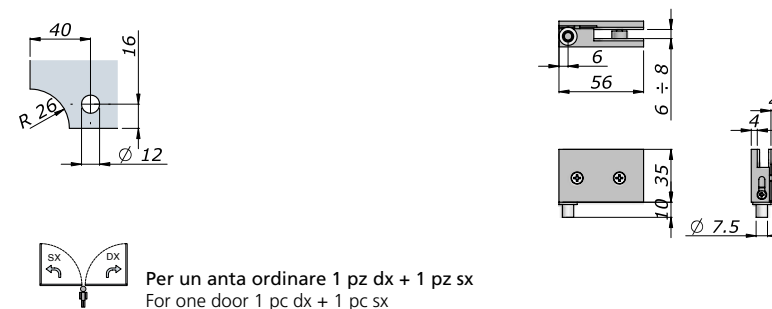

art. 170



Cerniera verticale per mobili
Vertical hinge for furniture

argento/silver	bronzo / bronze	oro / gold	nero / black	verniciato / powder	cromato / chrome	oro luc. / bright gold	crom. sat / chro. mat
N-0170-A-DX	N-0170-B-DX	N-0170-O-DX	N-0170-N-DX	N-0170-V-DX	N-0170-C-DX	N-0170-L-DX	N-0170-I-DX
N-0170-A-SX	N-0170-B-SX	N-0170-O-SX	N-0170-N-SX	N-0170-V-SX	N-0170-C-SX	N-0170-L-SX	N-0170-I-SX

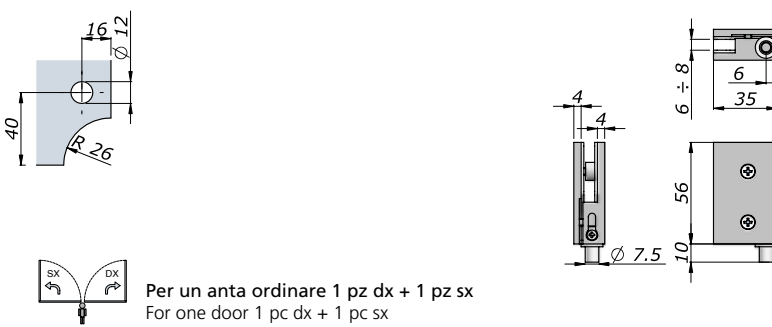

art. 171



Cerniera quadrata senza tacca per spessore max 5 mm
Square hinge without cutout for maximum 5 mm thickness

	cromato / chrome	oro lucido / bright gold	cromato satinato / chrome mat
Art. 171	N-0171-C	N-0171-L	N-0171-I
Art. 172	N-0172-C	N-0172-L	N-0172-I

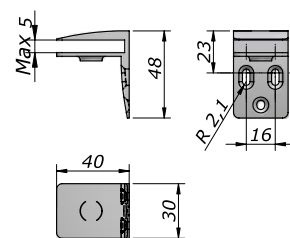

art. 172



Cerniera sagomata senza tacca per spessore max 5 mm
Oval hinge without cutout for maximum 5 mm thickness

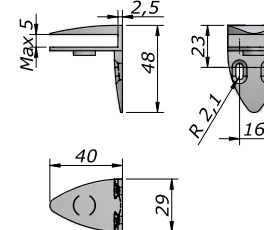

Sistema scorrevole per vetri da 6 mm di spessore
Sliding system for 6 mm glass thickness

art. 466 Kit scorrevole
art. 467 Guida singola
art. 468 Guida doppia
art. 469 Guida portavetro

art. 466 Sliding Kit
art. 467 Single sliding guide
art. 468 Double sliding guide
art. 469 Glass holder guide

Possibili fissaggi superiori
Different top fixing possibilities

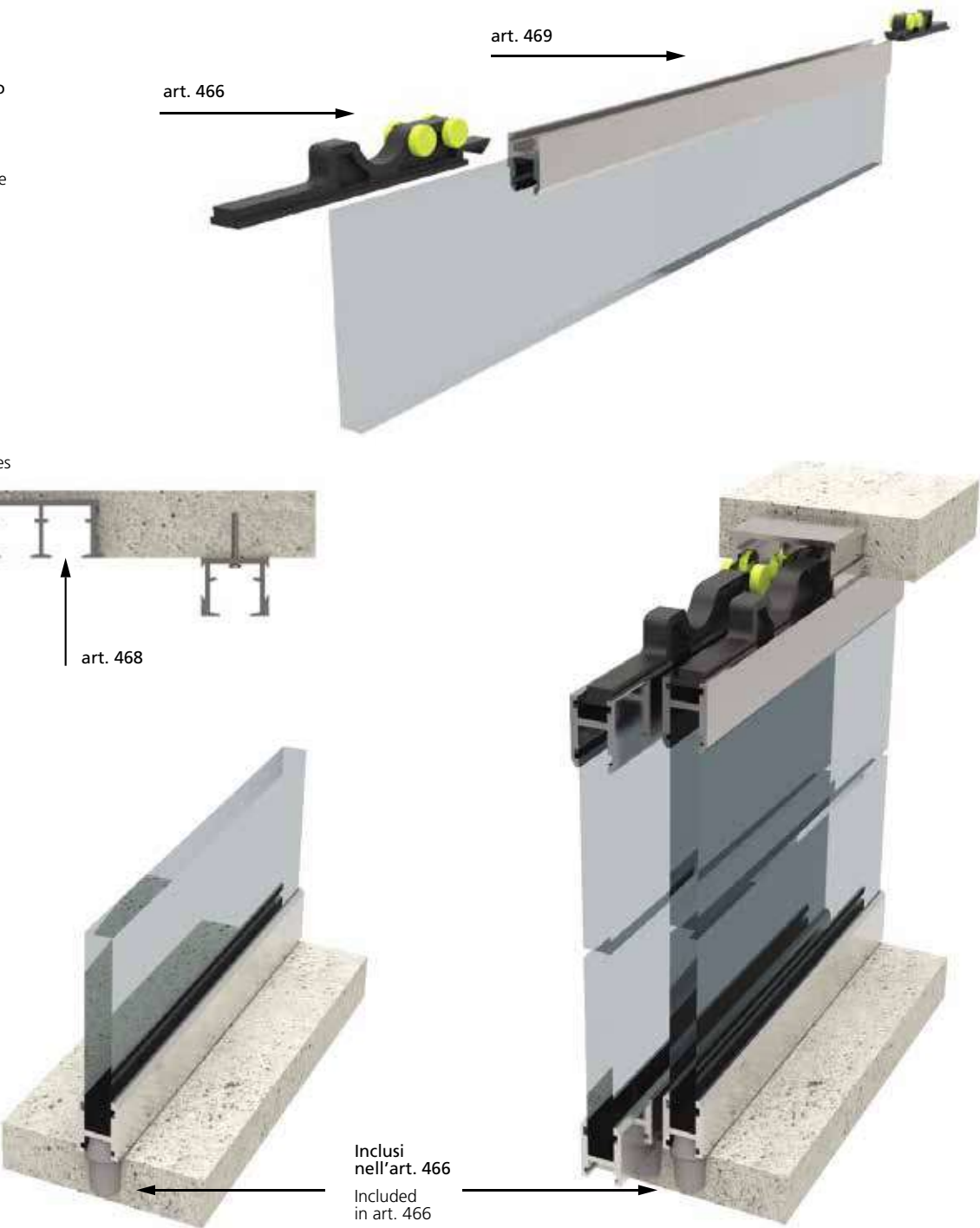
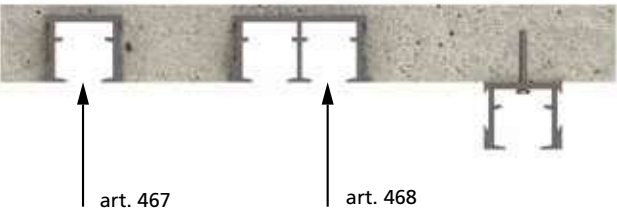

Possibili fissaggi inferiori
Different bottom fixing possibilities

Inclusi nell'art. 466
Included in art. 466

#1 Porta singola Single door	#3 Porta doppia Double door
No. 01 Art. 466	No. 02 Art. 466
No. 01 Art. 467 (L = misura anta x 2 / door width x 2)	No. 01 Art. 468 L = misura anta x 2 / door width x 2)
No. 01 Art. 469 (L = misura anta / door width)	No. 02 Art. 469 (L = misura anta / door width)
optional	optional
No. 01 Art. 469 (L = misura anta / door width)	No. 02 Art. 469 (L = misura anta / door width)

art. 466



Kit scorrevole per spessore max 6 mm
Sliding kit for 6 mm glass

argento/silver
N-0466-A

art. 467



Guida scorrevole singola per spessore 6 mm
Single sliding rail glass thickness max 6 mm

argento/silver
N-0467-A

art. 468



Guida scorrevole doppia per spessore max 6 mm
Double sliding rail glass thickness max 6 mm

argento/silver
N-0468-A

art. 469



Guida porta vetro per spessore max 6 mm
Glass holder guide glass thickness max 6 mm

argento/silver
N-0469-A

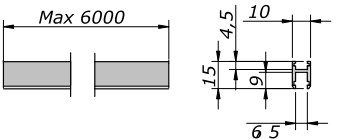
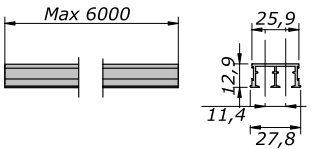
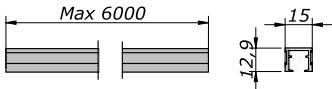
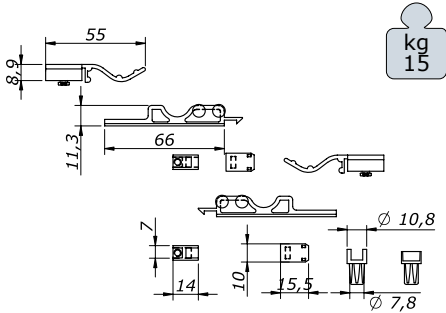

Serrature per mobili
Locks for furnitures



art. 180A

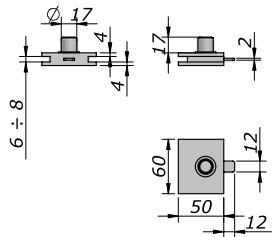
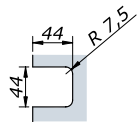

Serratura piccola per mobili
Small lock for furniture

argento/silver	bronzo / bronze	oro / gold	nero / black	verniciato / powder	cromato / chrome	oro luc. / bright gold	crom. sat / chro. mat
N-180A-A	N-180A-B	N-180A-O	N-180A-N	N-180A-V	N-180A-C	N-180A-L	N-180A-I

art. 181A

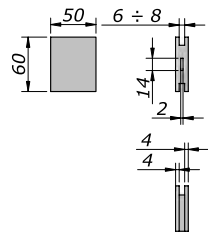
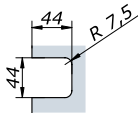

Contro per Art. 180/A
Lock keeper for Art. 180/A

argento/silver	bronzo / bronze	oro / gold	nero / black	verniciato / powder	cromato / chrome	oro luc. / bright gold	crom. sat / chro. mat
N-181A-A	N-181A-B	N-181A-O	N-181A-N	N-181A-V	N-181A-C	N-181A-L	N-181A-I

art. 313E

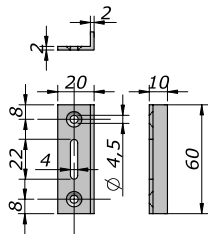

Battuta a 90° per Art. 180A
90° strike plate for Art. 180A

argento/silver	bronzo / bronze	oro / gold	nero / black	verniciato / powder	cromato / chrome	oro luc. / bright gold	crom. sat / chro. mat
N-313E-A	N-313E-B	N-313E-O	N-313E-N	N-313E-V	N-313E-C	N-313E-L	N-313E-I

art. 18 / 19

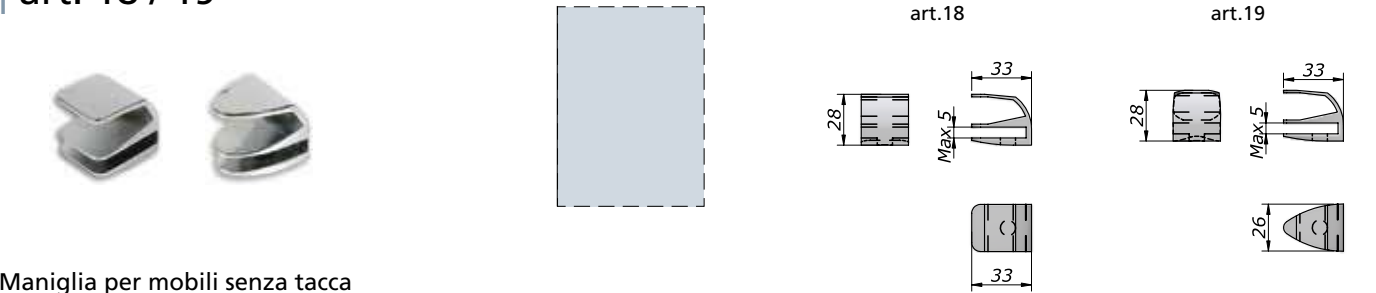

Maniglia per mobili senza tacca
Furniture handle without cut-out

	cromato / chrome	cromato satinato / crome mat
Art. 18	N-0018-C	N-0018-I
Art. 19	N-0019-C	N-0019-I

art. 286 / 296

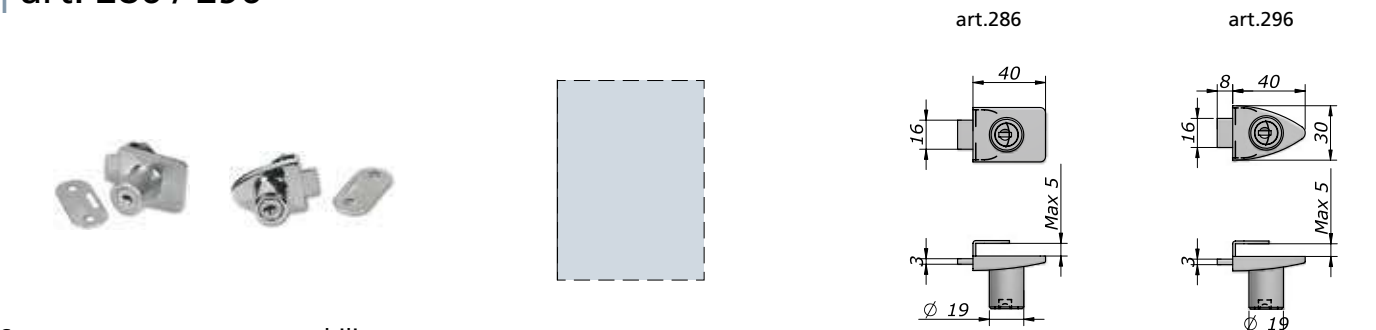

Serratura senza tacca per mobili
Small furniture lock without cut-out

	cromato / chrome	cromato satinato / crome mat
Art. 286	N-0286-C	N-0286-I
Art. 296	N-0296-C	N-0296-I

art. 287 / 297

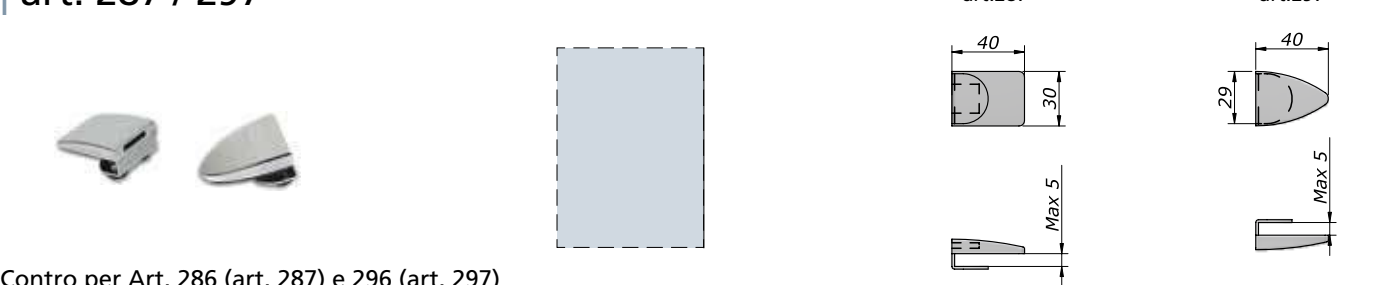

Contro per Art. 286 (art. 287) e 296 (art. 297)
Lock keeper for Art. 286 (art. 287) and 296 (art. 297)

	cromato / chrome	cromato satinato / crome mat
Art. 287	N-0287-C	N-0287-I
Art. 297	N-0297-C	N-0297-I

art. 288 / 298

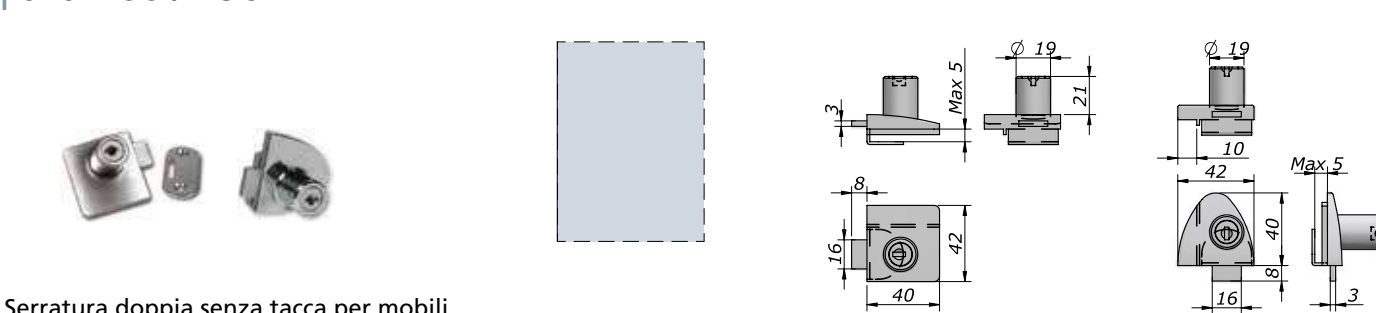

Serratura doppia senza tacca per mobili
Double furniture lock without cut-out

	cromato / chrome	cromato satinato / crome mat
Art. 288	N-0288-C	N-0288-I
Art. 298	N-0298-C	N-0298-I

art. 312C



Bocchetta a 180° per Art. 286/296-288/298
180° strike plate for Art.286/296/288/298

cromato / chrome	crom. sat / chro. mat
N-312C-C	N-312C-I

art. 294

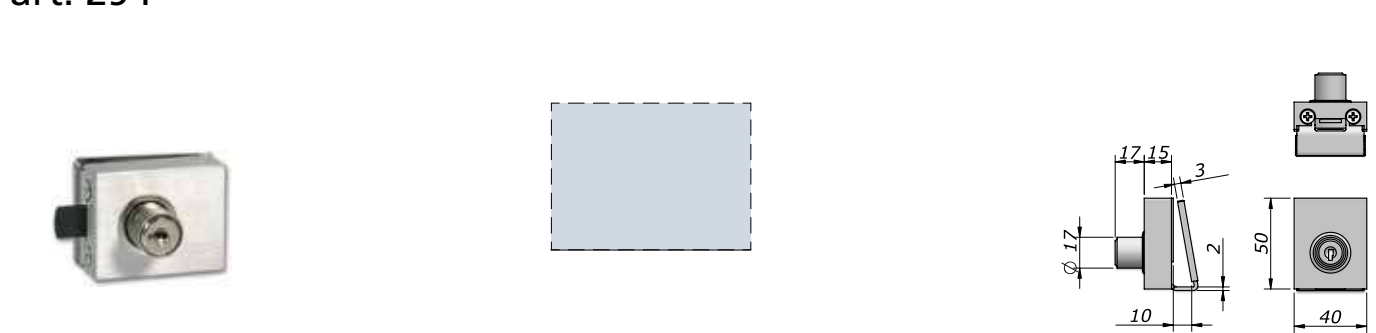

Serratura piccola senza tacca
Small lock without cut out

argento / silver	bronzo / bronze	oro / gold	nero / black	verniciato / powder	cromato / chrome	oro luc. / bright gold	crom. sat / chro. mat
N-0294-A	N-0294-B	N-0294-O	N-0294-N	N-0294-V	N-0294-C	N-0294-L	N-0294-I

art. 295

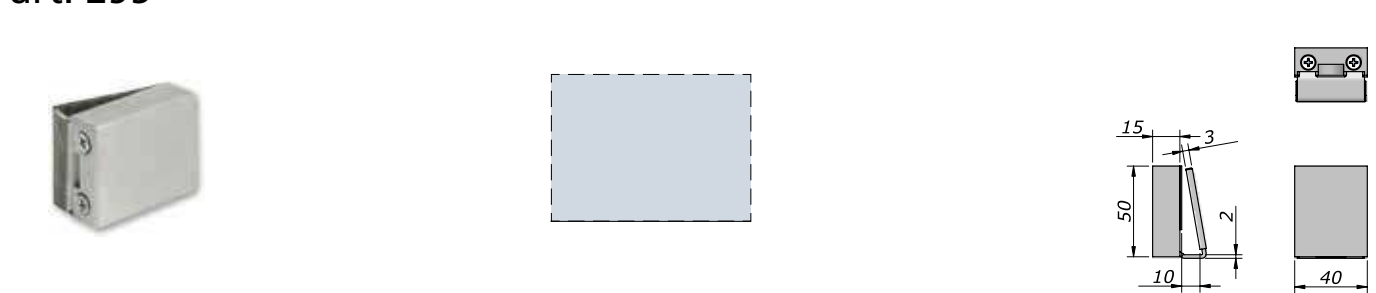

Contro per Art. 294
Lock keeper for Art. 294

argento / silver	bronzo / bronze	oro / gold	nero / black	verniciato / powder	cromato / chrome	oro luc. / bright gold	crom. sat / chro. mat
N-0295-A	N-0295-B	N-0295-O	N-0295-N	N-0295-V	N-0295-C	N-0295-L	N-0295-I

Reggimensola a morsetti Shelf supports and clamps



art. 317 / 317A



Reggimensola piccolo
Little shelf support

confezione 12 pz
box 12 pcs

art. 317

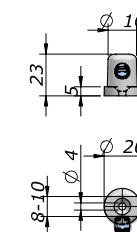

art. 317A

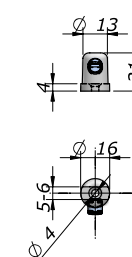

art. 318 / 318A

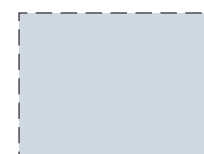

Reggimensola a mezzaluna
Half moon shelf support

confezione 2 pz
box 2 pcs

art. 318

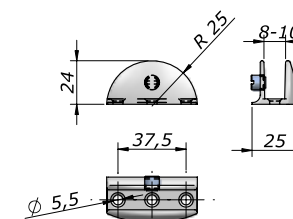

art. 318A

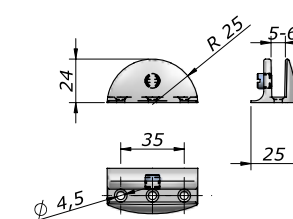

art. 319

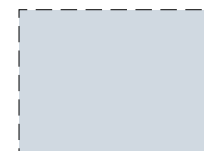

Morsetto regolabile da 3 a 20 mm
Adjustable clamp from 3 to 20 mm

confezione 2 pz
box 2 pcs

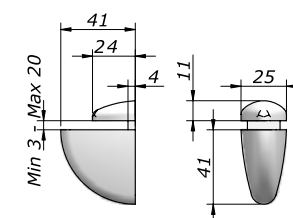

art. 320



Morsetto regolabile da 3 a 20 mm
Adjustable clamp from 3 to 20 mm

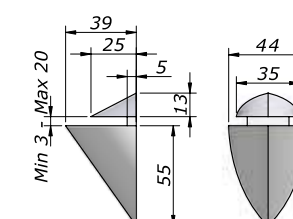

art. 322

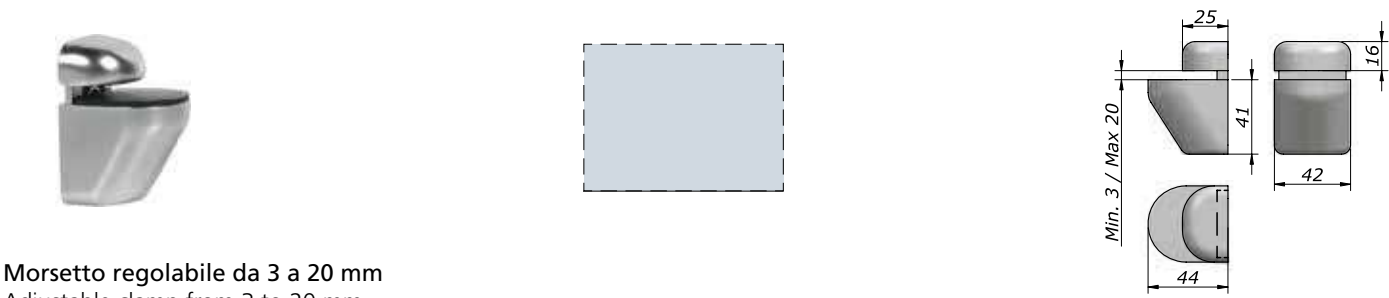

Morsetto regolabile da 3 a 20 mm
Adjustable clamp from 3 to 20 mm

nero / black	verniciato / powder	cromato / chrome	oro luc. / bright gold	crom. sat / chro. mat
N-0322-N	N-0322-V	N-0322-C	N-0322-L	N-0322-I

art. 323

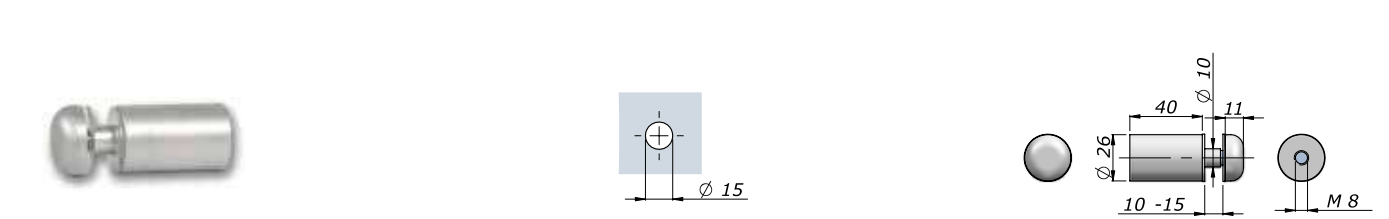

Distanziale con borchia
Spacer with cap

argento / silver	bronzo / bronze	oro / gold	nero / black	verniciato / powder	cromato / chrome	oro luc. / bright gold	crom. sat / chro. mat
N-0323-A	N-0323-B	N-0323-O	N-0323-N	N-0323-V	N-0323-C	N-0323-L	N-0323-I

art. 323A

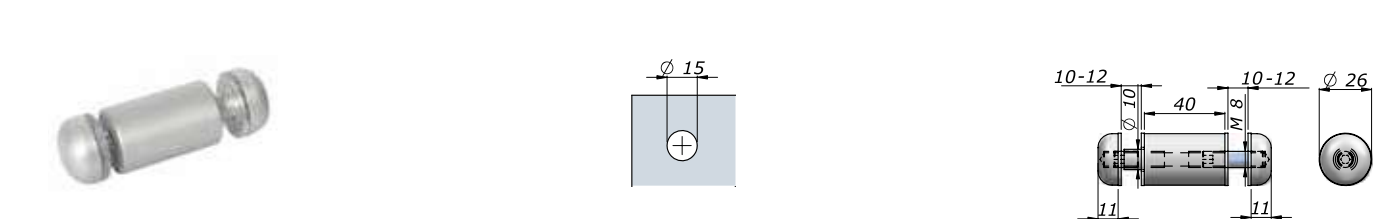

Distanziale con borchia doppia
Spacer with double cap

argento / silver	bronzo / bronze	oro / gold	nero / black	verniciato / powder	cromato / chrome	oro luc. / bright gold	crom. sat / chro. mat
N-323A-A	N-323A-B	N-323A-O	N-323A-N	N-323A-V	N-323A-C	N-323A-L	N-323A-I

art. 323B

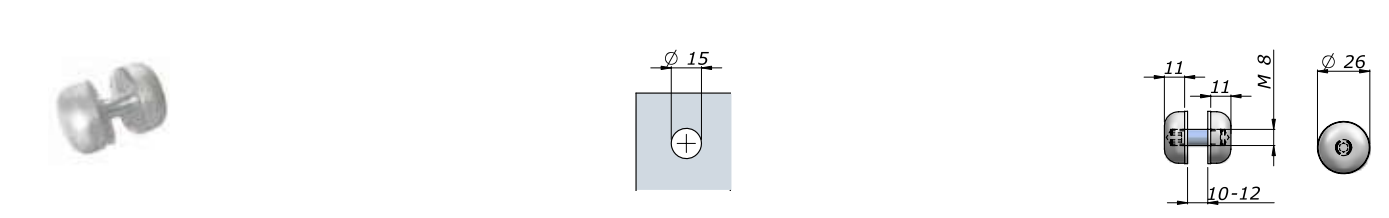

Doppia borchia
Double boss

argento / silver	bronzo / bronze	oro / gold	nero / black	verniciato / powder	cromato / chrome	oro luc. / bright gold	crom. sat / chro. mat
N-323B-A	N-323B-B	N-323B-O	N-323B-N	N-323B-V	N-323B-C	N-323B-L	N-323B-I

art. 3530

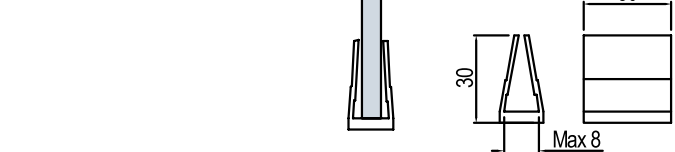

Piedino per spessore 6-8 mm
Small foot for 6-8 mm thickness









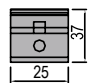

trasparente / transparent	nero / black
T-3530-T	T-3530-N

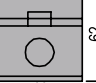
art. 3540

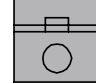

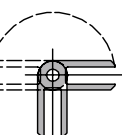
Piedino per spessore 10-12 mm
Small foot for 10-12 mm thickness

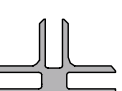
trasparente / transparent	nero / black
T-3540-T	T-3540-N

	Serie 200			Serie 2000			Serie 20		
									
	Per spessori da 6 a 8 mm For tickness 6 to 8 mm			Per spessori da 10 a 12 mm For thickness 10 to 12 mm			Per spessori da 18 a 20 mm For thickness 18 to 20 mm		
	argento lucido bright silver	oro lucido bright gold	nero lucido bright black	argento lucido bright silver	oro lucido bright gold	nero lucido bright black	argento lucido bright silver	oro lucido bright gold	nero lucido bright black
	-	-	-	T-1000-D	T-1000-L	T-1000-E	-	-	-
	T-0200-D	T-0200-L	T-0200-E	T-2000-D	T-2000-L	T-2000-E	T-0020-D	T-0020-L	T-0020-E
	T-0210-D	T-0210-L	T-0210-E	-	-	-	-	-	-
	T-0300-D	T-0300-L	T-0300-E	T-3000-D	T-3000-L	T-3000-E	T-0030-D	T-0030-L	T-0030-E
	T-0400-D	T-0400-L	T-0400-E	T-4000-D	T-4000-L	T-4000-E	T-0040-D	T-0040-L	T-0040-E
	T-0500-D	T-0500-L	T-0500-E	T-5000-D	T-5000-L	T-5000-E	T-0050-D	T-0050-L	T-0050-E
	T-0600-D	T-0600-L	T-0600-E	T-6000-D	T-6000-L	T-6000-E	-	-	-