



OXIDAL
your_project_partner

PARTIZIONI
PARTITIONS

Sistemi
partizioni
in vetro

Glass partitions
systems



Profilo a scatto
Snap fixing profile

Profilo di fissaggio perimetrale combinabile con sistema di fissaggio porta
Perimeter snap fixing profile can be combined with a door fixing system



Profilo porta con sopraluce
Door fixing profile with overpanel



Profilo porta tutta altezza
Door fixing profile full high



Profilo di battuta per porta
Door stop profile



Cerniere e serrature
Hinges and lock



Profilo a scatto
Snap profile

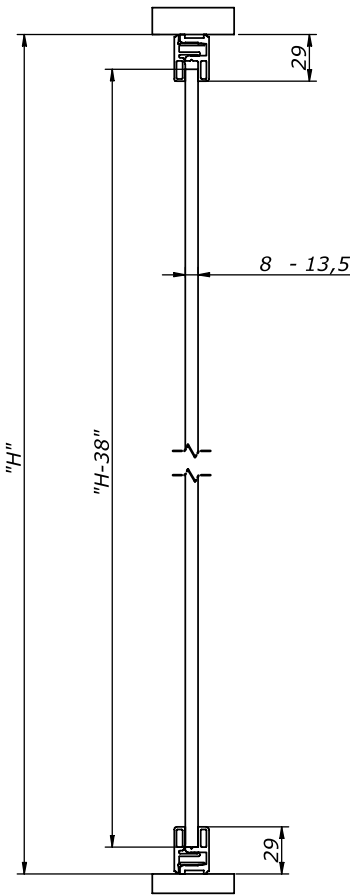

art. 520

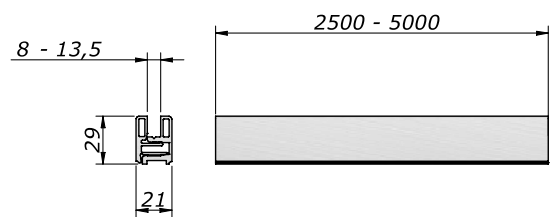
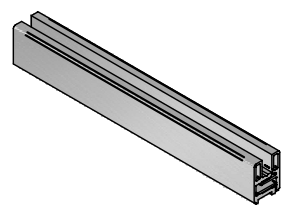

Profilo a scatto per vetri fissi
Snap profile for fixed glass

lunghezza / length	argento / silver	cromato satinato / chrome mat
mm 2500	N-0520-A-250	N-0520-I-250
mm 5000	N-0520-A-500	N-0520-I-500

art. 521

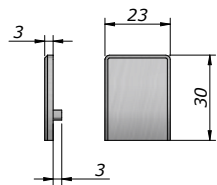

Tappo laterale per art. 520
Side cap for art. 520

argento / silver	cromato satinato / chrome mat
N-0521-A	N-0521-I



Morsetti
Clamps

| art. 303

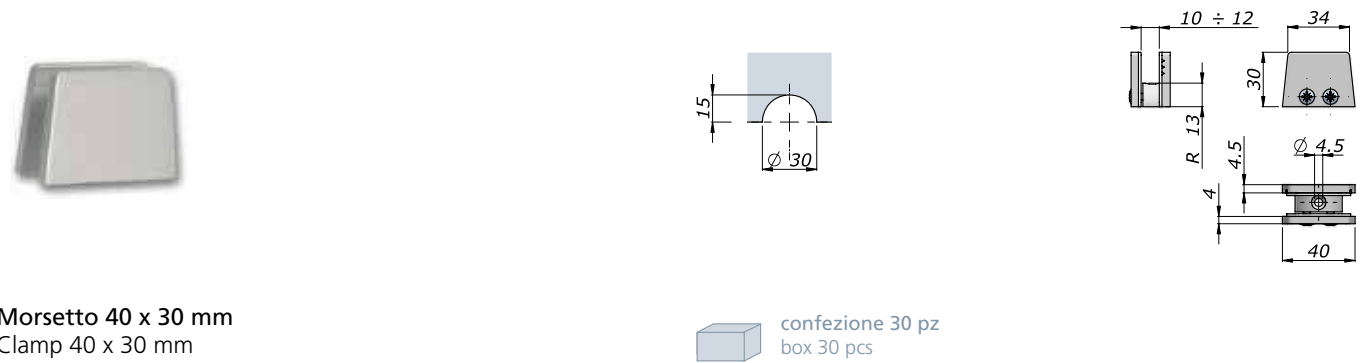

Morsetto 40 x 30 mm
Clamp 40 x 30 mm



confezione 30 pz
box 30 pcs

argento/silver	bronzo / bronze	oro / gold	nero / black	verniciato / powder	cromato / chrome	oro luc. / bright gold	crom. sat / chro. mat
N-0303-A	N-0303-B	N-0303-O	N-0303-N	N-0303-V	N-0303-C	N-0303-L	N-0303-I

| art. 304

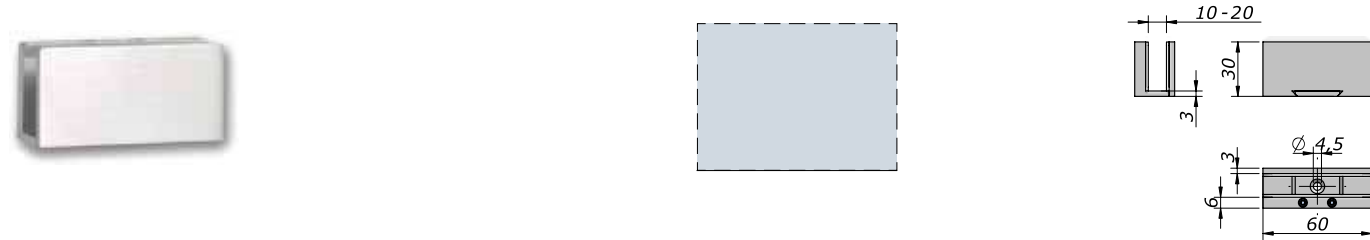

Morsetto senza tacca
Clamp without cut out



confezione 20 pz
box 20 pcs

spessore/thickness	argento/silver	bronzo/bronze	oro/gold	nero/black	verniciato/powder	cromato/chrome	oro luc./bright gold	crom. sat/chro. mat
max 12 mm	N-0304-A	N-0304-B	N-0304-O	N-0304-N	N-0304-V	N-0304-C	N-0304-L	N-0304-I
max 14 mm	N-0304-A-14	-	-	-	-	N-0304-C-14	-	N-0304-I-14
max 18 mm	N-0304-A-18	-	-	-	-	N-0304-C-18	-	N-0304-I-18
max 20 mm	N-0304-A-20	-	-	-	-	N-0304-C-20	-	N-0304-I-20

| art. 305

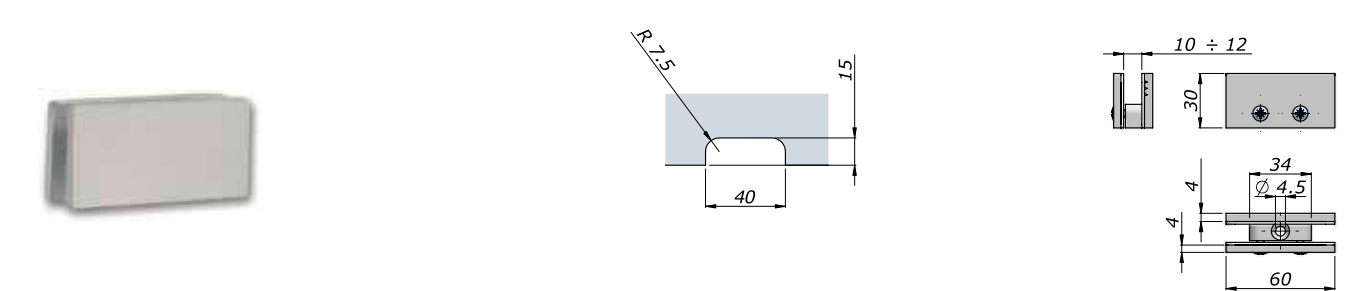

Morsetto standard 60 x 30 mm
Standard clamp 60 x 30 mm



confezione 20 pz
box 20 pcs

argento/silver	bronzo / bronze	oro / gold	nero / black	verniciato / powder	cromato / chrome	oro luc. / bright gold	crom. sat / chro. mat
N-0305-A	N-0305-B	N-0305-O	N-0305-N	N-0305-V	N-0305-C	N-0305-L	N-0305-I

| art. 305A

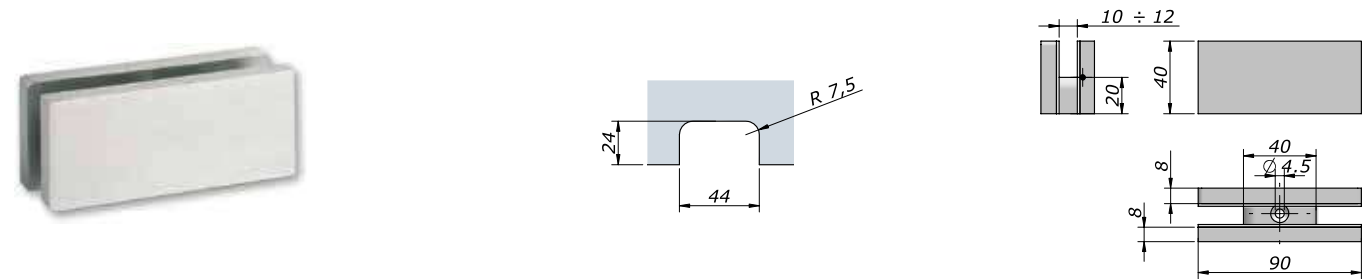

Morsetto 90 x 40 mm
Clamp 90 x 40 mm

argento/silver	bronzo / bronze	oro / gold	nero / black	verniciato / powder	cromato / chrome	oro luc. / bright gold	crom. sat / chro. mat
N-305A-A	N-305A-B	N-305A-O	N-305A-N	N-305A-V	N-305A-C	N-305A-L	N-305A-I

| art. 305B

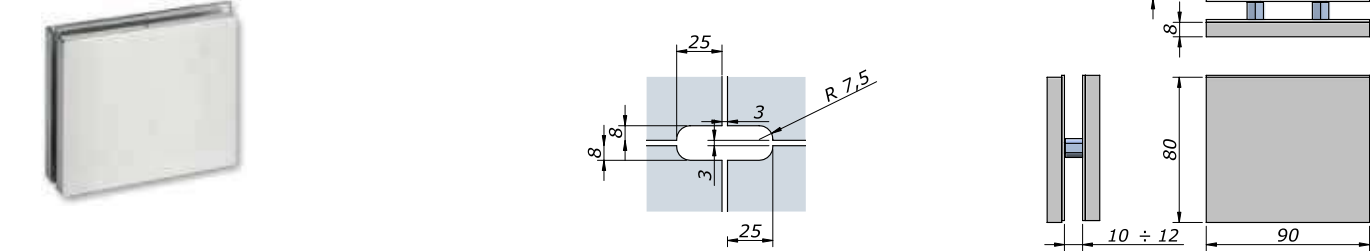

Morsetto centrale
Central clamp

argento/silver	bronzo / bronze	oro / gold	nero / black	verniciato / powder	cromato / chrome	oro luc. / bright gold	crom. sat / chro. mat
N-305B-A	N-305B-B	N-305B-O	N-005B-N	N-305B-V	N-305B-C	N-305B-L	N-305B-I

| art. 309

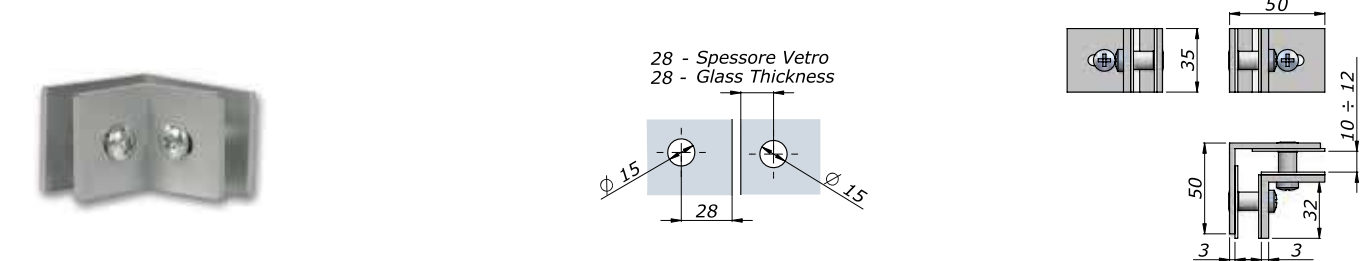

Morsetto angolare
Angled clamp

argento/silver	bronzo / bronze	oro / gold	nero / black	verniciato / powder	cromato / chrome	oro luc. / bright gold	crom. sat / chro. mat
N-0309-A	N-0309-B	N-0309-O	N-0309-N	N-0309-V	N-0309-C	N-0309-L	N-0309-I

| art. 309A

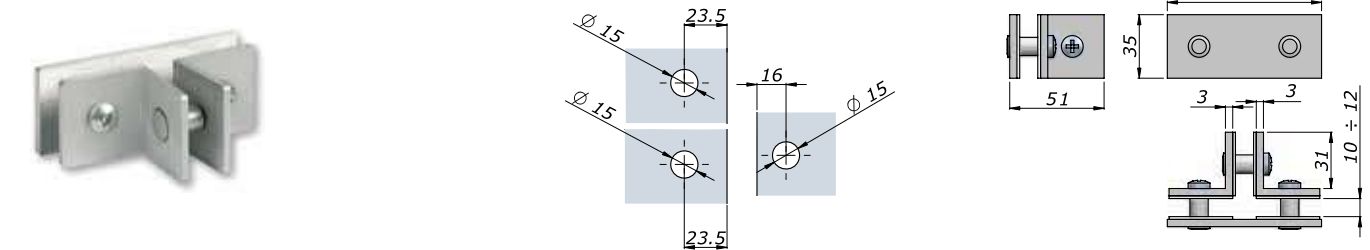

Morsetto a tre vie
Three ways clamp

argento/silver	bronzo / bronze	oro / gold	nero / black	verniciato / powder	cromato / chrome	oro luc. / bright gold	crom. sat / chro. mat
N-309A-A	N-309A-B	N-309A-O	N-309A-N	N-309A-V	N-309A-C	N-309A-L	N-309A-I



art. 350

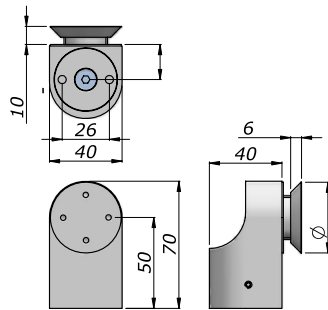
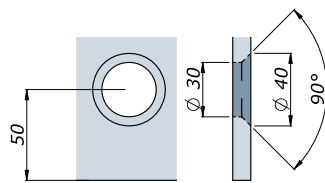

Morsetto con borchia svasata
Point fixed clamp with countersunk boss

argento/silver	bronzo / bronze	oro / gold	nero / black	verniciato / powder	cromato / chrome	oro luc. / bright gold	crom. sat / chro. mat
N-0350-A	N-0350-B	N-0350-O	N-0350-N	N-0350-V	N-0350-C	N-0350-L	N-0350-I

art. 351

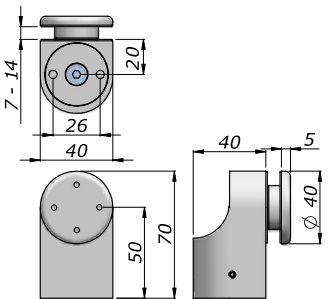
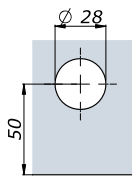

Morsetto con borchia piatta
Point fixed clamp with flat boss

argento/silver	bronzo / bronze	oro / gold	nero / black	verniciato / powder	cromato / chrome	oro luc. / bright gold	crom. sat / chro. mat
N-0351-A	N-0351-B	N-0351-O	N-0351-N	N-0351-V	N-0351-C	N-0351-L	N-0351-I

art. 352

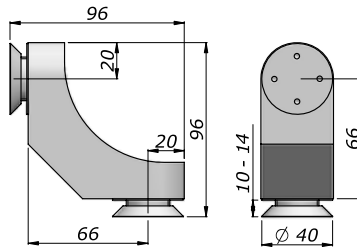
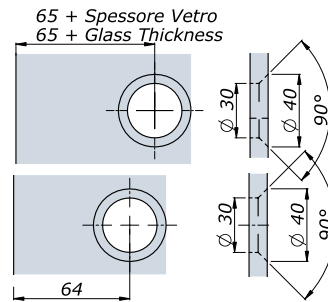

Morsetto angolare con borchie svasate
Angular point fixed clamp with countersunk bosses

argento/silver	bronzo / bronze	oro / gold	nero / black	verniciato / powder	cromato / chrome	oro luc. / bright gold	crom. sat / chro. mat
N-0352-A	N-0352-B	N-0352-O	N-0352-N	N-0352-V	N-0352-C	N-0352-L	N-0352-I

art. 353

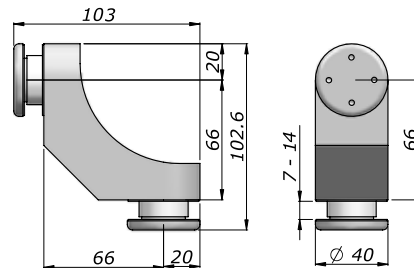
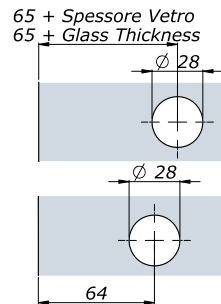

Morsetto angolare con borchie piatte
Angular point fixed clamp with flat bosses

argento/silver	bronzo / bronze	oro / gold	nero / black	verniciato / powder	cromato / chrome	oro luc. / bright gold	crom. sat / chro. mat
N-0353-A	N-0353-B	N-0353-O	N-0353-N	N-0353-V	N-0353-C	N-0353-L	N-0353-I

art. 354

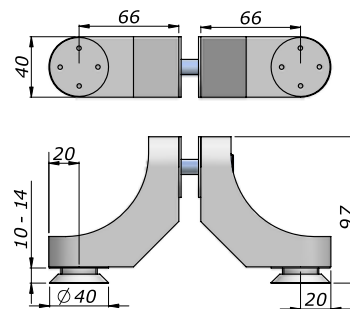
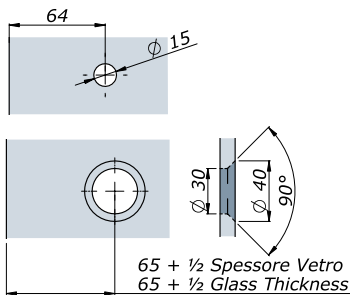

Morsetto a tre vie con borchie svasate
Point fixed three ways clamp countersunk bosses

argento/silver	bronzo / bronze	oro / gold	nero / black	verniciato / powder	cromato / chrome	oro luc. / bright gold	crom. sat / chro. mat
N-0354-A	N-0354-B	N-0354-O	N-0354-N	N-0354-V	N-0354-C	N-0354-L	N-0354-I

art. 355

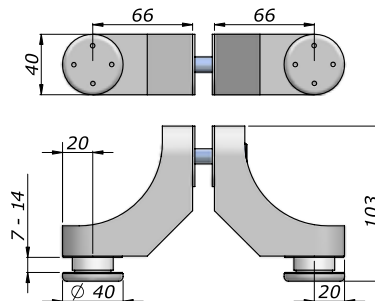
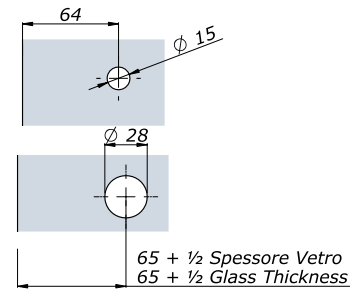

Morsetto a tre vie con borchie piatte
Point fixed three ways clamp flat bosses

argento/silver	bronzo / bronze	oro / gold	nero / black	verniciato / powder	cromato / chrome	oro luc. / bright gold	crom. sat / chro. mat
N-0355-A	N-0355-B	N-0355-O	N-0355-N	N-0355-V	N-0355-C	N-0355-L	N-0355-I



Profili perimetrali
Perimeter profiles

art. 342

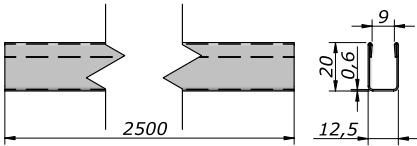

Profilo a “U” per spessore 8 mm (lungh. 2500)
“U” Profile for 8 mm thickness (length 2500)

inox satinato / mat stainless steel	inox lucido / polished stainless steel
N-0342-H	N-0342-M

art. 343

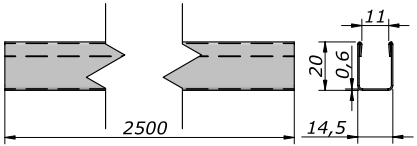

Profilo a “U” per spessore 10 mm (lungh. 2500)
“U” Profile for 10 mm thickness (length 2500)

inox satinato / mat stainless steel	inox lucido / polished stainless steel
N-0343-H	N-0343-M

art. 344 / 345

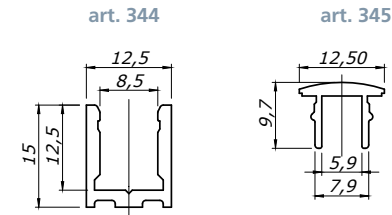
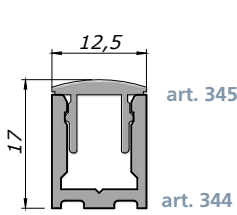
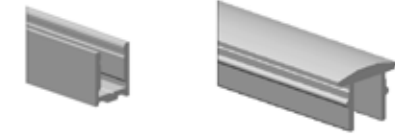

Profilo a “U” per spess. 8 mm / Profilo di copertura per art. 344 (lungh. 2500 mm)
“U” profile for 8 mm thickness / Cover profile for art. 344 (length 2500 mm)

	argento/silver	nero/black	oro lucido/bright gold	cromato sat/chrome mat	argento brillante/bright silver
Art. 344	N-0344-A	N-0344-N	N-0344-L	N-0344-I	N-0344-D
Art. 345	N-0345-A	N-0345-N	N-0345-L	N-0345-I	N-0345-D

art. 520

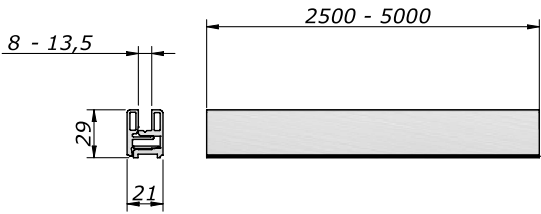
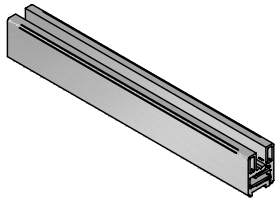

Profilo a scatto per vetri fissi
Snap profile for fixed glass

lunghezza / length	argento / silver	cromato satinato / chrome mat
mm 2500	N-0520-A-250	N-0520-I-250
mm 5000	N-0520-A-500	N-0520-I-500

art. 751

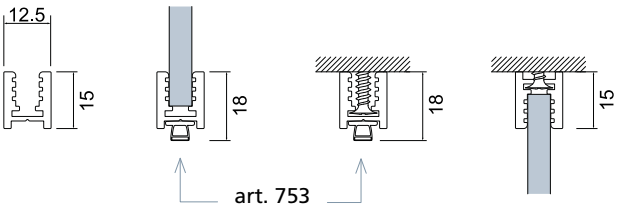

Profilo a “U” per spessore 6 mm lungh. 2500
“U” profile for 6 mm glass length 2500

argento/silver	nero/black	oro lucido/bright gold	cromato sat/chrome mat	argento brill./bright silver
N-0751-A	N-0751-N	N-0751-L	N-0751-I	N-0751-D

art. 752

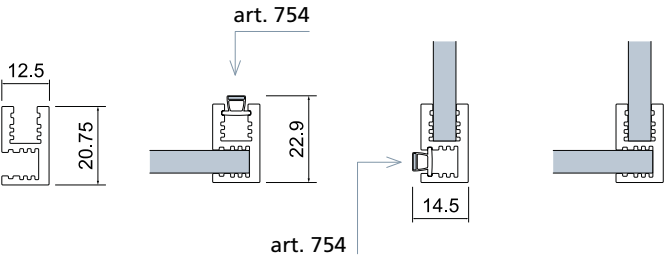
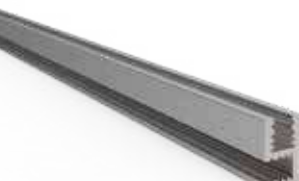

Profilo di fissaggio angolare per spessore 6 mm lungh. 2500
Corner fixing profile for 6 mm glass length 2500

argento/silver	nero/black	oro lucido/bright gold	cromato sat/chrome mat	argento brill./bright silver
N-0752-A	N-0752-N	N-0752-L	N-0752-I	N-0752-D

art. 753



Magnete adesivo per profilo Art. 751 lungh. 2500
Adhesive magnetic profile for Art. 751 length 2500

art. 753
lungh./ length 2500

art. 754



Magnete per profilo Art. 752 lungh. 2500
Magnetic profile for Art. 752 length 2500

art. 754
lungh./ length 2500

Supporti snodati Articulated connections



Esempi di composizione / Composition examples

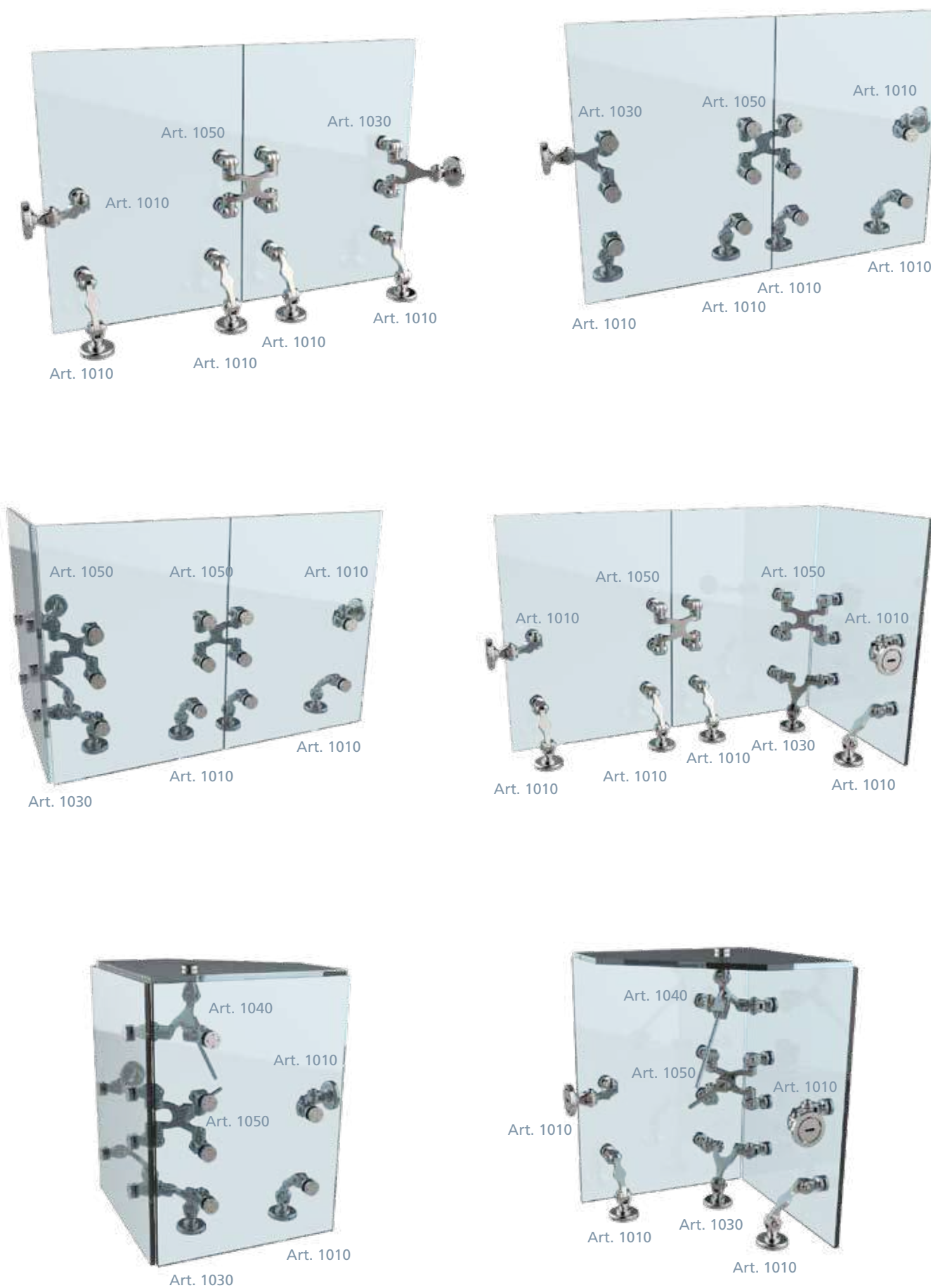

Esempi di forature (per inclinazioni differenti contattare il ns. ufficio)
Drilling examples (for other inclinations please contact our technical office)

1020

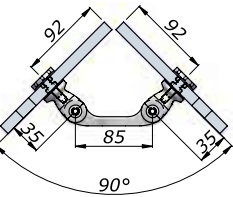

Angolo vetri: 90° / 90° angle

1030

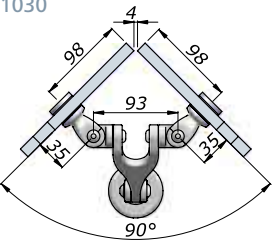

Angolo vetri: 90° / 90° angle

1040



1050

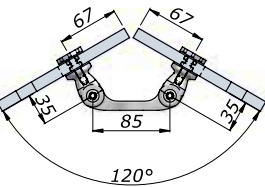

Angolo vetri: 120° / 120° angle

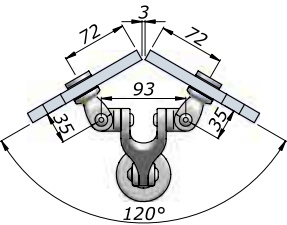

Angolo vetri: 120° / 120° angle

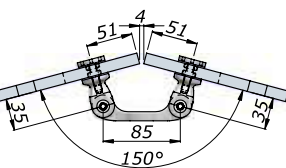

Angolo vetri: 150° / 150° angle

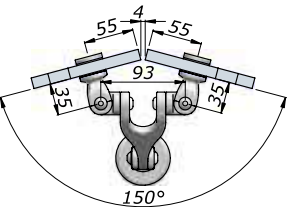

Angolo vetri: 150° / 150° angle

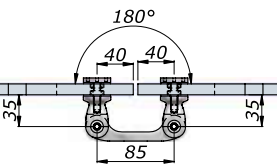

Angolo vetri: 180° / 180° angle

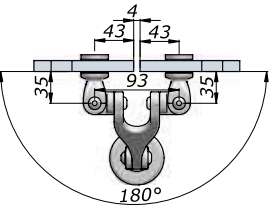

Angolo vetri: 180° / 180° angle

art. 1020 /1030 angolo / angle	opzione 1 option 1	opzione 1 option 2
	L=	In caso di sovrapposizione degli angoli aggiungere alla quota "L" indicata lo spessore del vetro (es. 90° = 92 + 10 mm)
90°	92	
100°	82	
110°	74	
120°	67	
140°	56	
150°	51	
160°	47	
170°	43	
180°	40	

art. 1010



Connessione snodata a due vie (muro-vetro)
Two ways articulated connection fitting

argento/silver	cromato / chrome	crom. sat / chro. mat	altre finiture / other finishes
N-1010-A	N-1010-C	N-1010-I	a richiesta / on demand

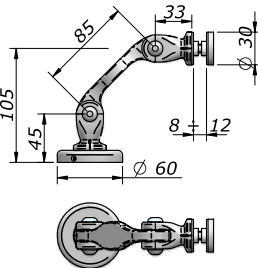
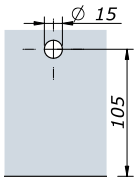

art. 1020



Connessione snodata a due vie (vetro-vetro)
Two ways articulated connection fitting

argento/silver	cromato / chrome	crom. sat / chro. mat	altre finiture / other finishes
N-1020-A	N-1020-C	N-1020-I	a richiesta / on demand

art. 1030

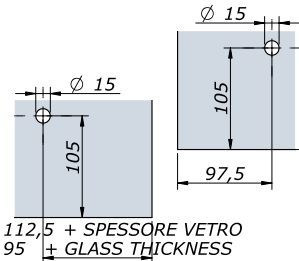

Connessione snodata a tre vie (muro-vetro-vetro)
Three ways articulated connection fitting

argento/silver	cromato / chrome	crom. sat / chro. mat	altre finiture / other finishes
N-1030-A	N-1030-C	N-1030-I	a richiesta / on demand

art. 1040

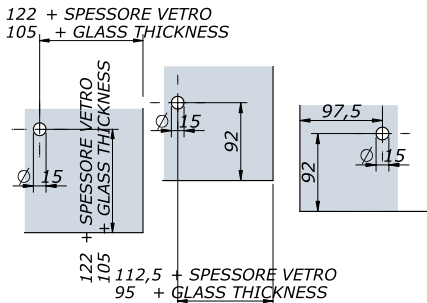

Connessione snodata a tre vie (vetro-vetro-vetro)
Three ways articulated connection fitting

argento/silver	cromato / chrome	crom. sat / chro. mat	altre finiture / other finishes
N-1040-A	N-1040-C	N-1040-I	a richiesta / on demand

art. 1050

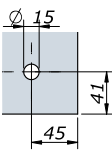

Connessione snodata a quattro vie
Four ways articulated glass connection

argento/silver	cromato / chrome	crom. sat / chro. mat	altre finiture / other finishes
N-1050-A	N-1050-C	N-1050-I	a richiesta / on demand

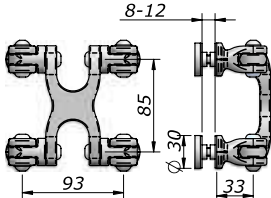

Distanziali e Borchie
Spacer and fixing bolt

art. 323

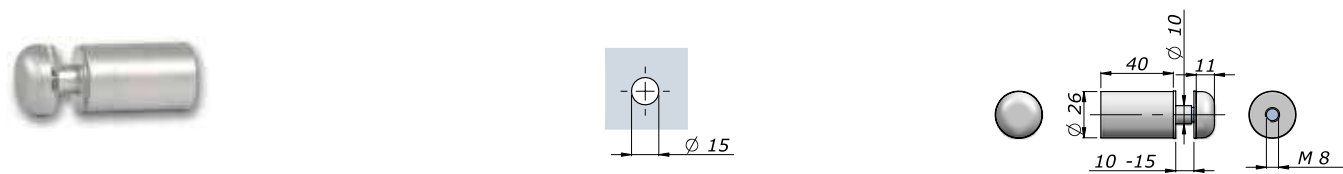

Distanziale con borchia
Spacer with cap

argento/silver	bronzo / bronze	oro / gold	nero / black	verniciato / powder	cromato / chrome	oro luc. / bright gold	crom. sat / chro. mat
N-0323-A	N-0323-B	N-0323-O	N-0323-N	N-0323-V	N-0323-C	N-0323-L	N-0323-I

art. 323A

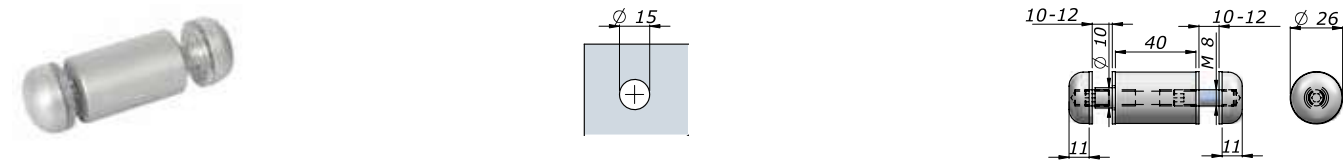

Distanziale con borchia doppia
Spacer with double cap

argento/silver	bronzo / bronze	oro / gold	nero / black	verniciato / powder	cromato / chrome	oro luc. / bright gold	crom. sat / chro. mat
N-323A-A	N-323A-B	N-323A-O	N-323A-N	N-323A-V	N-323A-C	N-323A-L	N-323A-I

art. 323B

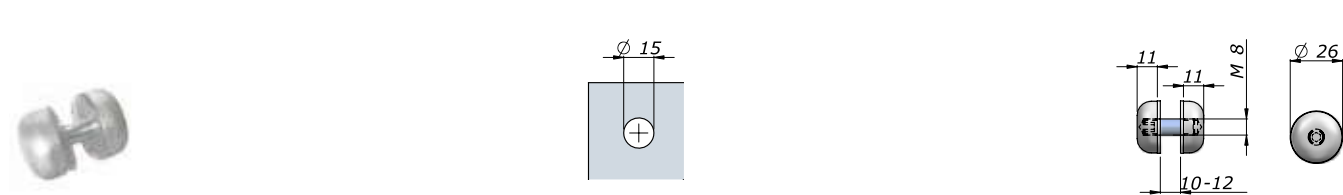

Doppia borchia
Double boss

argento/silver	bronzo / bronze	oro / gold	nero / black	verniciato / powder	cromato / chrome	oro luc. / bright gold	crom. sat / chro. mat
N-323B-A	N-323B-B	N-323B-O	N-323B-N	N-323B-V	N-0323B-C	N-0323B-L	N-323B-I

art. COMBO E

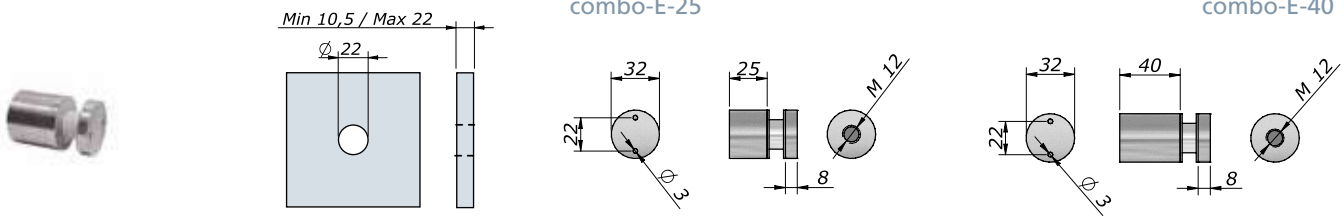

Vite di fissaggio a muro con distanziale h 25/40 borchia piatta diam. 32
Fixed screw with flat ring diam. 32 with wall fixing, spacer h. 24/40

distanziale h 25 / spacer h 25	distanziale h 40 / spacer h 40
V- COMBO-E-25	V-COMBO-E-40

art. COMBO F

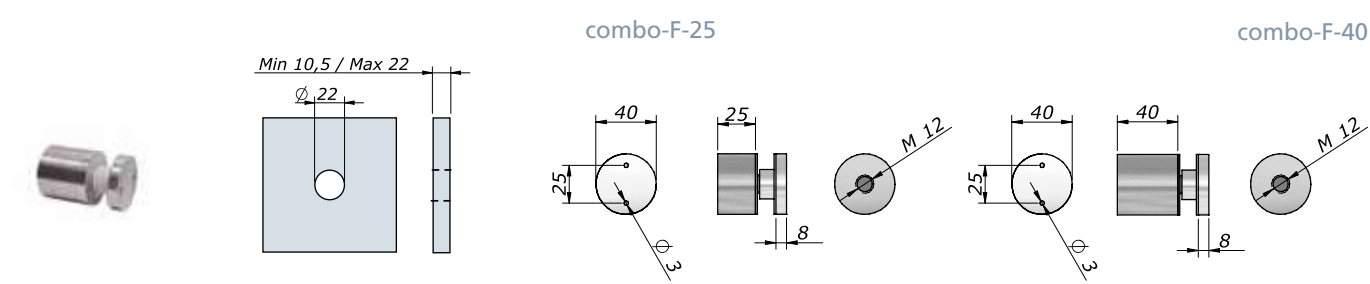

Vite di fissaggio a muro con distanziale h 25/40 borchia piatta diam. 32
Fixed screw with flat ring diam. 32 with wall fixing, spacer h. 24/40

distanziale h 25 / spacer h 25	distanziale h 40 / spacer h 40
V- COMBO-F-25	V-COMBO-F-40

art. ERA F

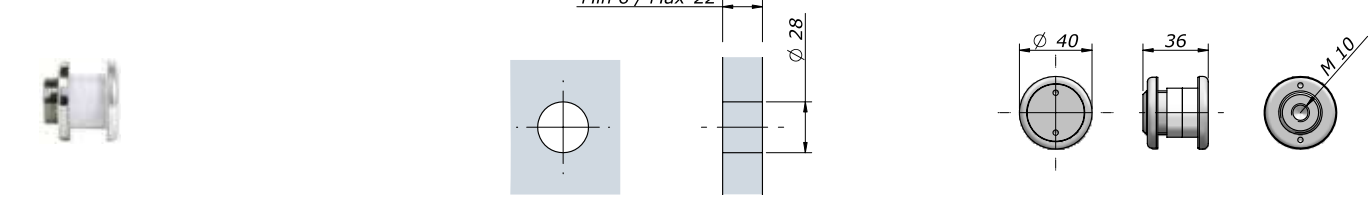

Vite fissa con ghiera piatta diametro 40 mm
Fixed screw with flat ring of 40 mm diameter

V-ERA-F

art. ERA G

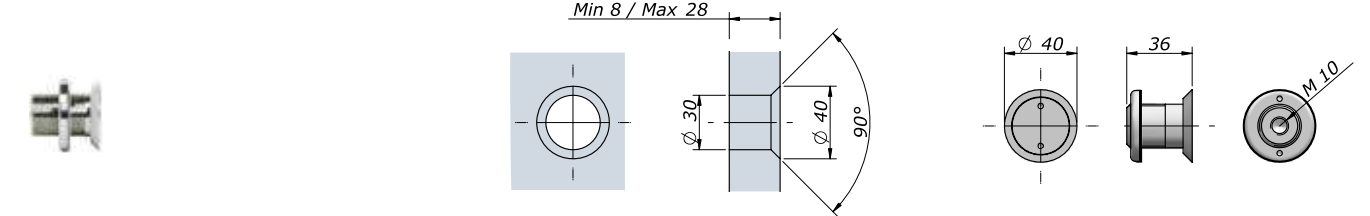

Vite fissa con ghiera svasata
Fixed screw with countersunk ring

V-ERA-G

art. ERA H

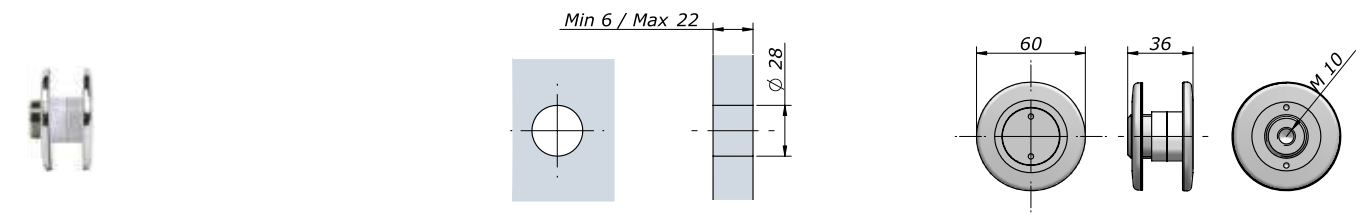

Vite fissa con ghiera piatta diametro 60 mm
Fixed screw with flat ring of 60 mm diameter

V-ERA-H

Mini sistema modulare Mini modular system



Mini

Sistema modulare per pareti divisorie, arredamento e allestimenti fieristici.

I profili di sostegno sono facilmente combinabili e adatti alla realizzazione di pareti divisorie, complementi d'arredo, scrivanie o elementi multifunzionali.

Gli elementi di fissaggio del vetro possono essere inseriti sui quattro lati del profilo senza forature, facilmente rimovibili e riposizionabili.

Utilizzabile anche con sistema puntuale Vetra System

Caratteristiche principali:

- Materiale: Alluminio
- Portata supporti: 50 kg. Per punto
- Altezza max profili: mm 6000
- Taglio a misura effettuabile a richiesta
- Spessori vetro utilizzabili 8 - 13,52
- Finiture standard: argento
- Finiture a richiesta: altre finiture anodizzato e RAL

Mini

Modular system for partition walls, furnishings and exhibition stands.

Bearing supporting profiles are easily combinable and suitable for realization of partition walls, furnishing complements, desks or multifunctional elements.

Glass fixing elements can be inserted on the four profile sides without any holes, all accessories can be easily removed and repositioned.

Systems can be used with Vetra System punctual system elements

Main features:

- Material: Aluminum
- Support capacity: 50 kg. per point
- Max profile length 6000 mm
- Cut to size available upon request
- Glass thickness 8 - 13.52
- Standard finishes: silver
- Finishes on request: other anodized and RAL finishes

Dettaglio sistema di fissaggio e dimensionamento
Fixing details and dimensioning scheme

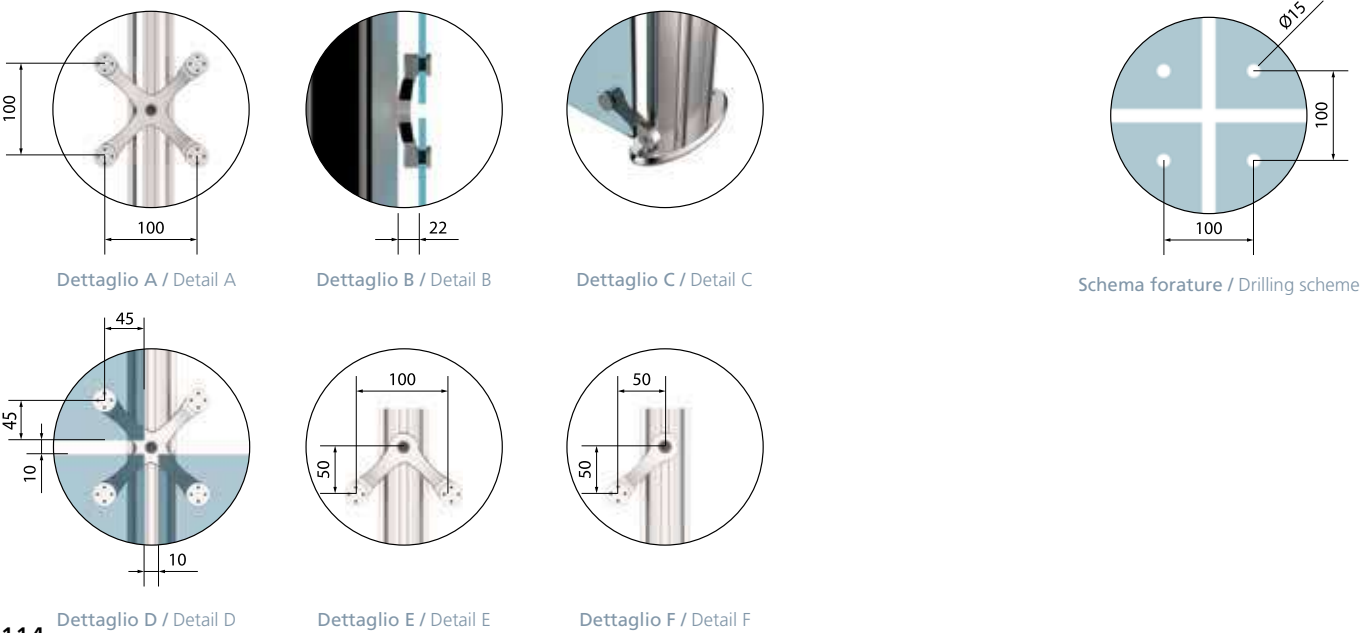
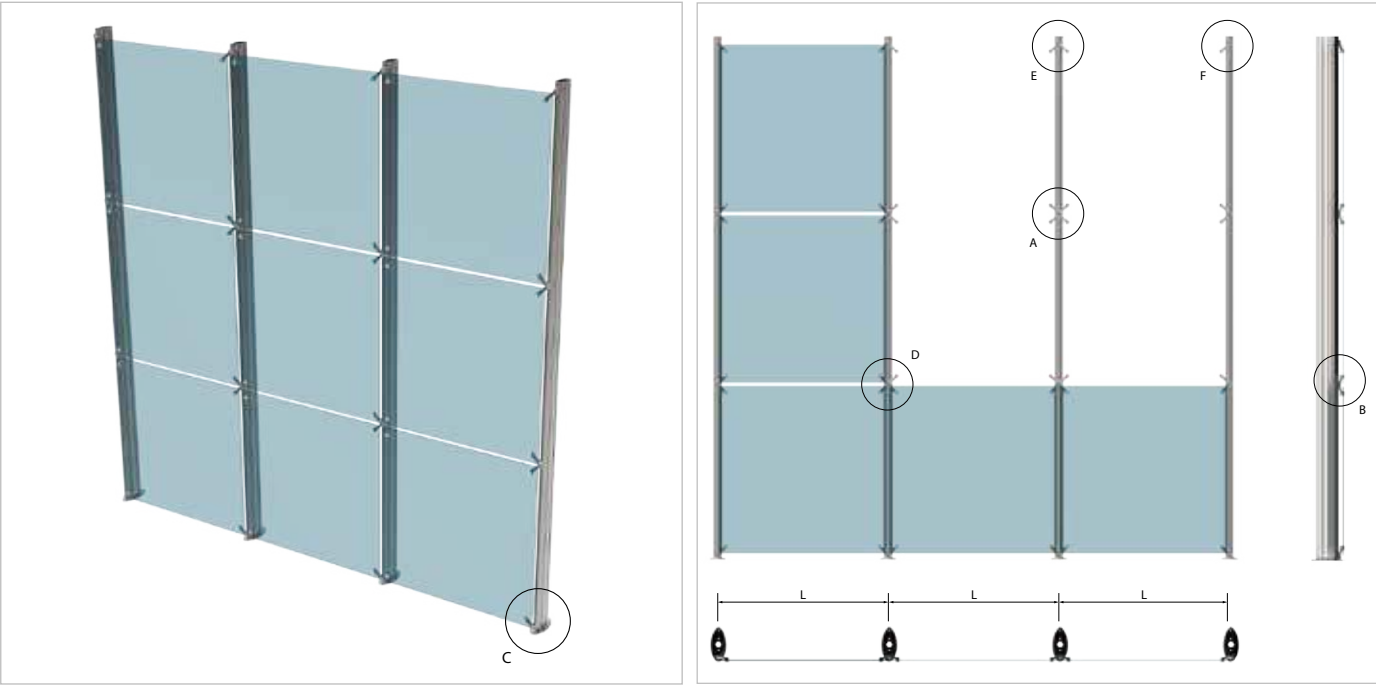
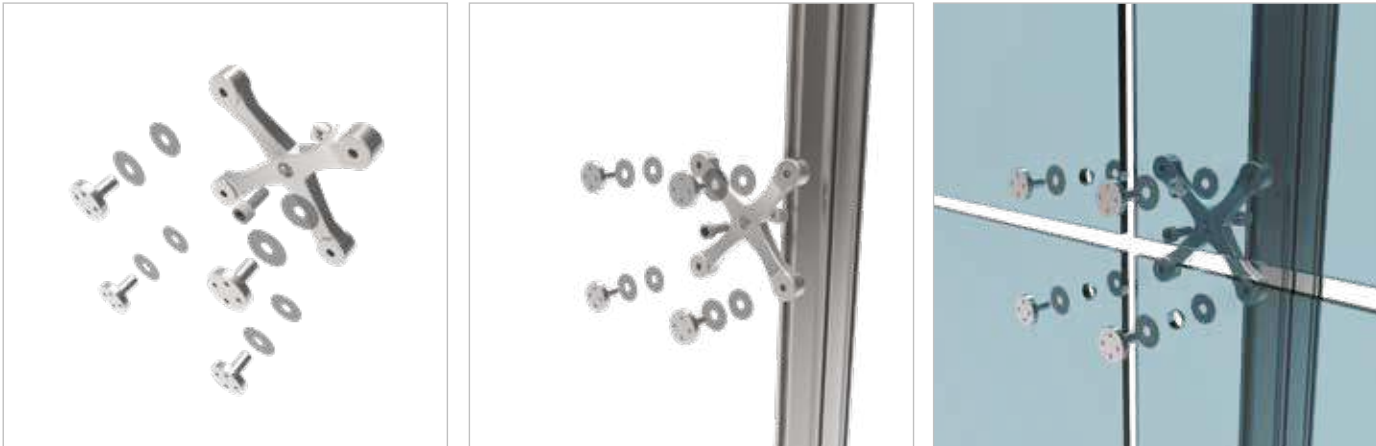

art. AS 01



Supporto a quattro bracci in alluminio
Aluminium four arms support

M-AS01-A

art. AS 02



Supporto a tre bracci in alluminio
Aluminium three arms support

M-AS02-A

art. AS 03



Supporto a due bracci in alluminio
Aluminium two arms support

M-AS03-A

art. AS 04



Supporto a un braccio in alluminio
Aluminium one arm support

M-AS04-A

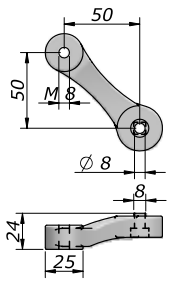
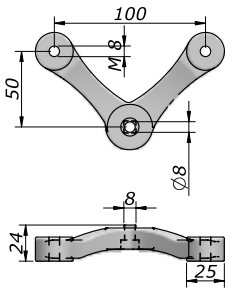
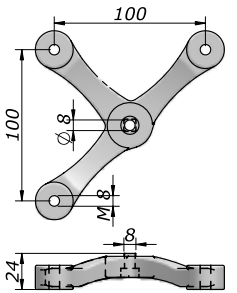
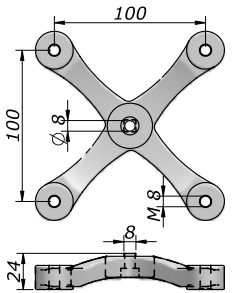

| art. AS 05



Supporto a quattro bracci in materiale trasparente
Four arms support in special transparent polycarbonate

M-AS05-A

| art. AS 07



Supporto a due bracci in materiale trasparente
Two arms support in special transparent polycarbonate

M-AS07-A

| art. AS 08



Supporto a un braccio in materiale trasparente
One arm support in special transparent polycarbonate

M-AS08-A

| art. AS 09



Borchia con testa piatta (spessore max 8 mm)
Flat head boss M8x15 (maximum thickness 8 mm)

M-AS09-A

| art. AS 10



Borchia con testa piatta (spessore max 12 mm)
Flat head boss M8x20 (maximum thickness 12 mm)

M-AS10-A

| art. AS 14



Rondella con vite M8x20 (spessore max 12 mm)
Washer Washer with screw M8x20 (maximum thickness 12 mm)

M-AS14-A

| art. AA 01



Vite di fissaggio supporti Mini
Fixing screw for Mini supports

M-AA01-A

| art. AA 03



Blocchetto di fissaggio per vite M8
Fixing block for M8 screw

M-AA03-A

Dettaglio fissaggio su qualsiasi profilo serie Mini
Fastenign detail on any Mini profile

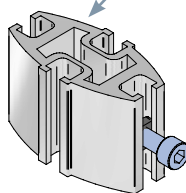

ART. AA01

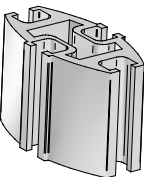

ART. AA03



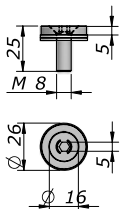
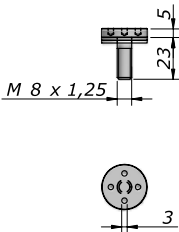

ART. AA01



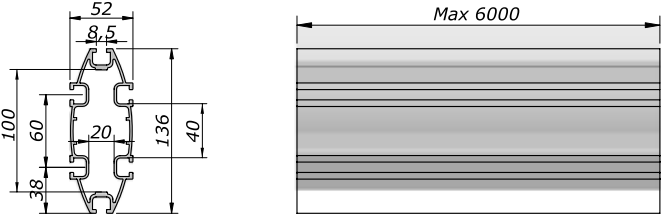

art. AP 01





Profilo di supporto
Aluminium supporting profile

M-AP01-A

NB:
specificare lunghezza in caso d'ordine
length has to be specified while ordering

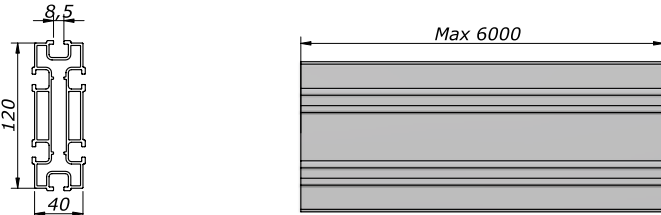
art. AP 02





Profilo 40x120
Profile 40x120

M-AP02-A

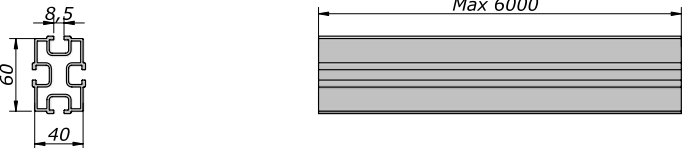

NB:
specificare lunghezza in caso d'ordine
length has to be specified while ordering

art. AP 03



NB:
specificare lunghezza in caso d'ordine
length has to be specified while ordering

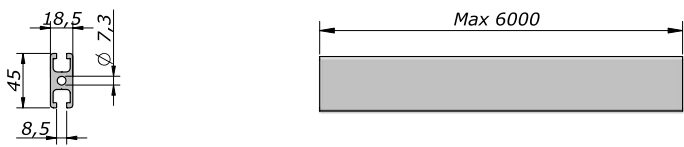

art. AP 06



Traverso
Joist

NB:
specificare lunghezza in caso d'ordine
length has to be specified while ordering

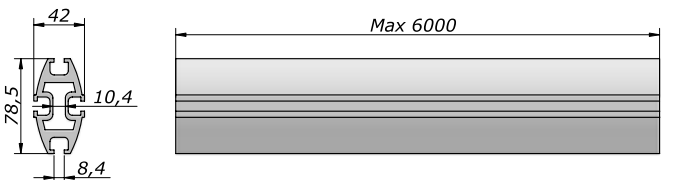

art. APS 01



Profilo di supporto piccolo
Aluminium small supporting profile

NB:
specificare lunghezza in caso d'ordine
length has to be specified while ordering

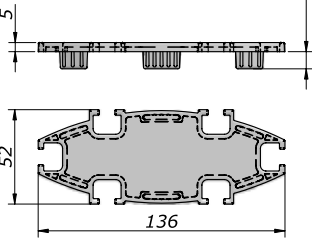

art. AT 01



Tappo di chiusura profilo Art. AP-01
End cap for Art. AP-01

M-AT01-A

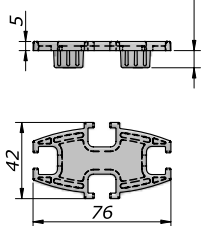
art. ATS 01



Tappo di chiusura profilo Art. APS-01
End cap for Art. APS-01

M-ATS01-A



art. AD 01



Piede fisso per Art. AP-01
Fixed foot for Art. AP-01

M-AD01-A

art. AD 02



Piede planetario snodato
Planetary articulated foot

M-AD02-A

art. AD 04



Piede planetario snodato "Big"
Planetary articulated foot "Big"

M-AD04-A

art. AD 07



Piede regolabile per Art. AP-01
Adjustable foot for Art. AP-01

M-AD07-A

art. ADS 01



Piede fisso per Art. APS-01
Fixed foot for Art. APS-01

M-ADS01-A

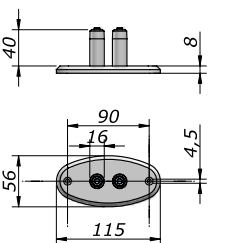
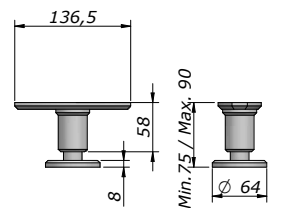
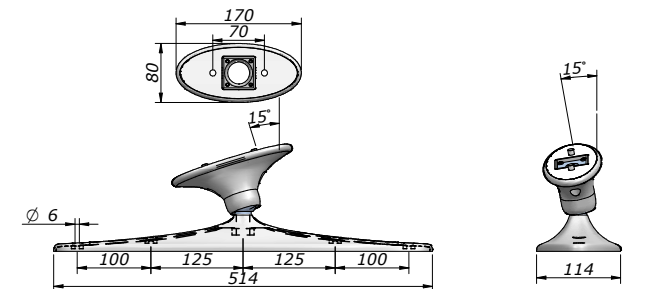
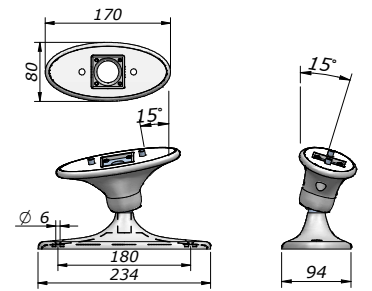

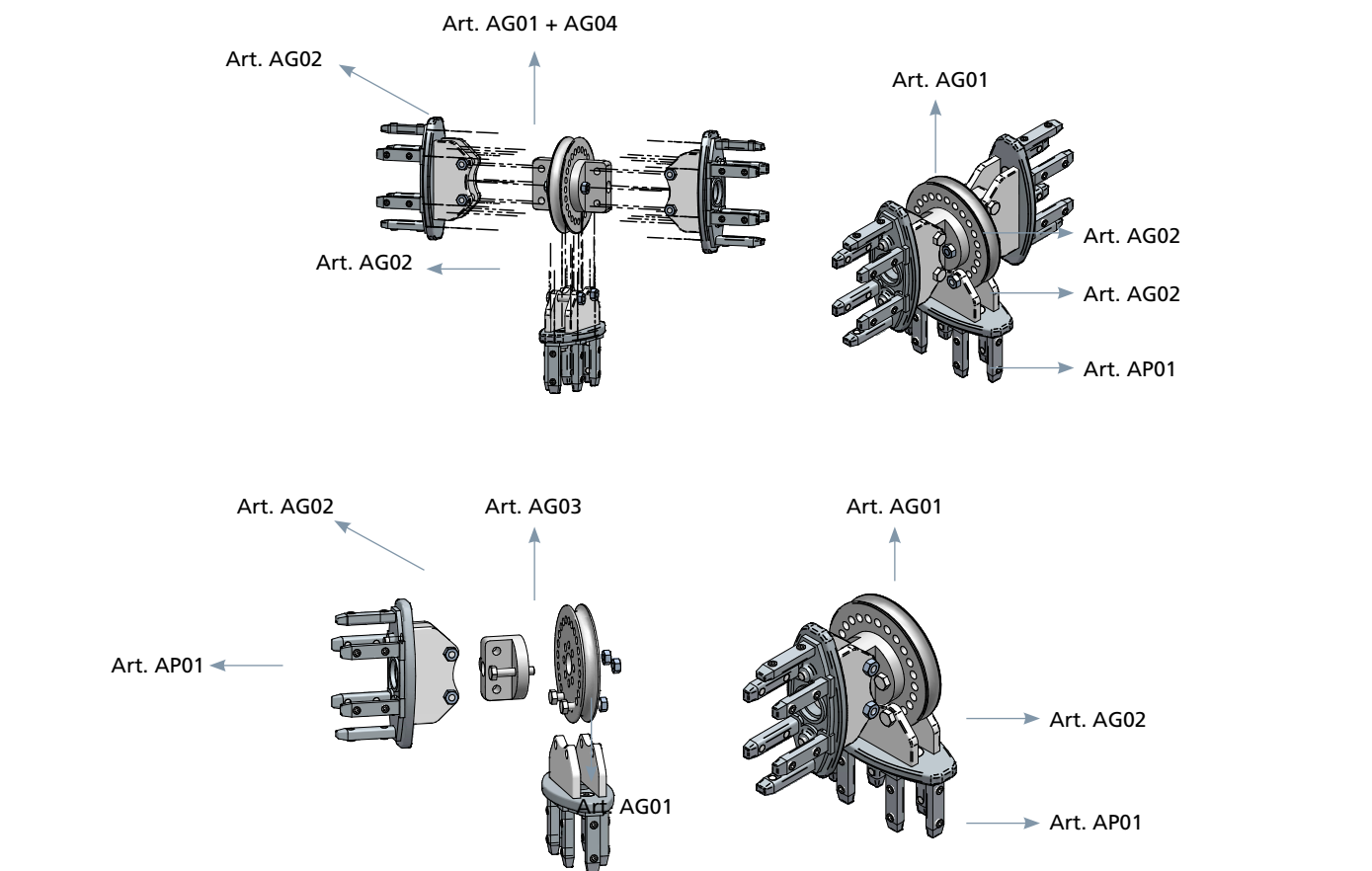

art. AG 01

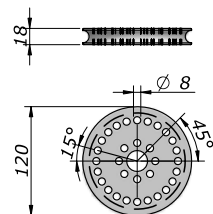

Puleggia per snodo circolare a sei direzioni
Pulley for articulated joint with six directions

M-AG01-A

art. AG 03

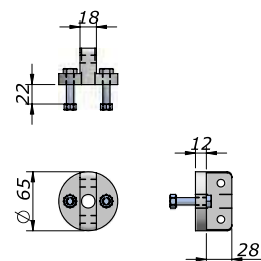

Giunto singolo a "T" per snodo circolare a sei direzioni
"T" connection for articulated joint with six directions

M-AG03-A

art. AG 02

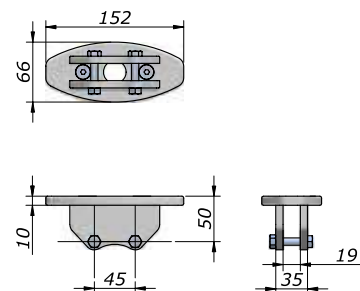

Basetta per snodo circolare a sei direzioni
Base for articulated joint with six directions

M-AG02-A

art. AG 04

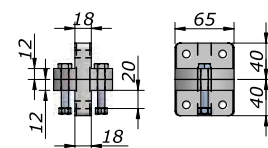

Giunto a "T" doppio per snodo circolare a sei direzioni
Double "T" connection for articulated joint with six directions

M-AG04-A

art. AA 05

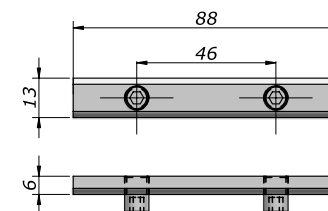

Prolunga di connessione
Extension connection fitting

M-AA05-A

art. AA 12

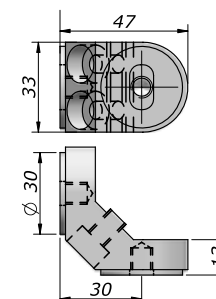

Connessione profilo-supporto a 45°
45° connection profile-support

M-AA12-A

Esempi di composizione
Composition examples

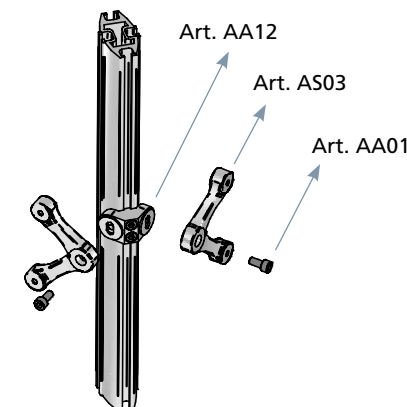

art. AA 06

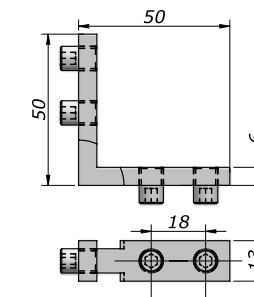

Angolare di connessione
Angular connection fitting

M-AA06-A

art. AA 13

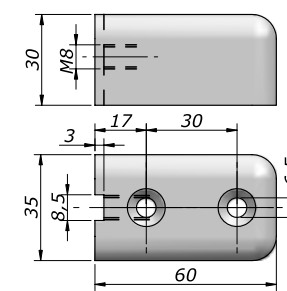

Fissaggio a muro per supporti Mini
Wall fastening fitting for Mini supports

M-AA13-A

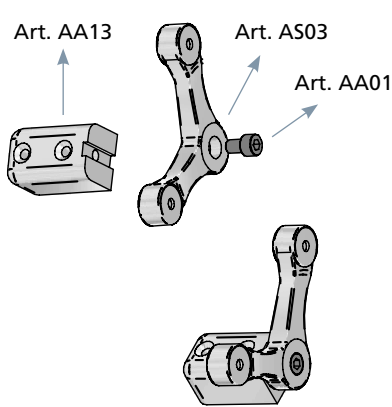

art. AA 07

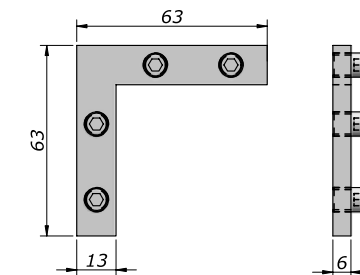

Squadretta di connessione
90° connection fitting

M-AA07-A

art. AA 14

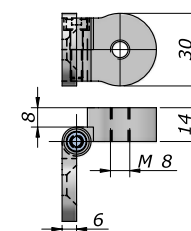

Fissaggio regolabile per angoli
Adjustable fastening fitting for corners

M-AA14-A

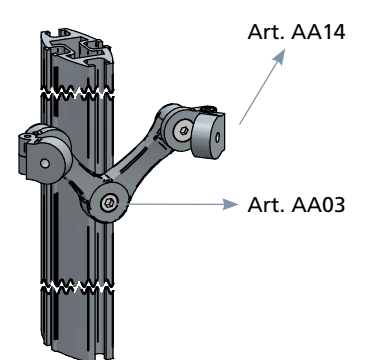



art. AC 02

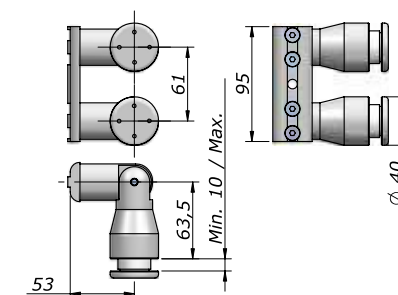
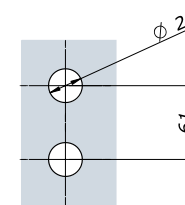

Cerniera verticale con doppia borchia piatta
Vertical hinge with double flat boss

M-AC02-A

art. AC 05

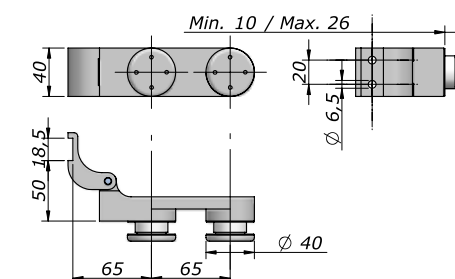
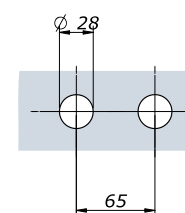

Cerniera orizzontale con doppia borchia piatta
Flag hinge with flat bosses

M-AC05-A

art. AC 08

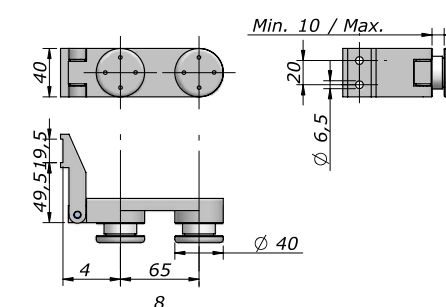
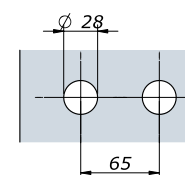

Cerniera per apertura a tirare con doppia borchia svasata
Pull opening flag hinge with flat bosses

M-AC08-A

| art. AA 02

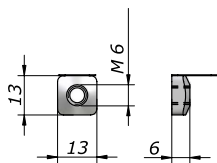

Blocchetto di fissaggio per vite M6
Fixing block for M6 screw

M-AA02-A

| art. AA 04

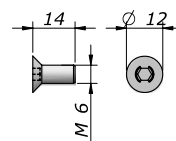

Vite di fissaggio M6
Fixing screw M6

M-AA04-A

Dettaglio fissaggio su qualsiasi profilo serie Mini
Fastenign detail on any Mini profile

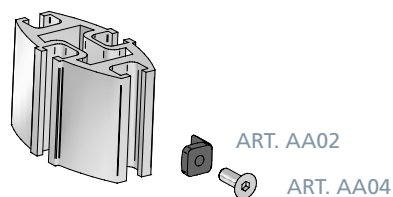
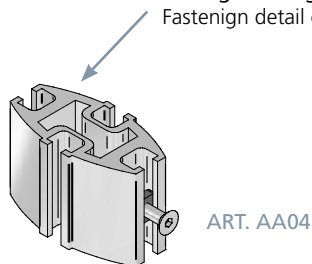

| art. AR 00

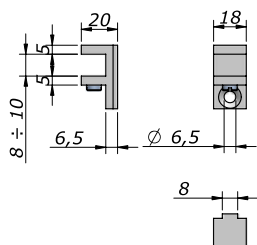

Reggimensola
Shelf support

M-AR00-A

| art. AR 01

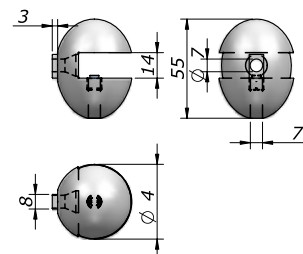

Reggimensola "Uovo"
Shelf support "Uovo"

M-AR01-A